



IMPORTANT – THIS COMMUNICATION AFFECTS YOUR PROPERTY

**TOWN AND COUNTRY PLANNING (SCOTLAND) ACT 1997
(AS AMENDED)**

PLANNING CONTRAVENTION NOTICE

REFERENCE NUMBER: ED2022/0037/ENF

SERVED BY: East Dunbartonshire Council

SERVED TO: Person Who Has an Interest in the Land:

**Mr S. Williamson
Bluebell Lodge
Craigmaddie Road
Bardowie
East Dunbartonshire
G62 6EY**

- 1. THIS IS A FORMAL NOTICE** served under the provisions of section 125 of the Town and Country Planning (Scotland) Act 1997 (as amended) (hereinafter referred to as “the Act”) by East Dunbartonshire Council (hereinafter referred to as “the Council”) as Planning Authority in terms of section 1 of the Act because it appears to the Council that there **may** have been a breach of planning control as defined by Section 123(1) of this Act at the land described below. It is served on you as a person who appears to be the owner or occupier of the land or has another interest in it, or who is carrying out operations in, on, over or under the land or is using it for any purpose. The Council require you, in exercise of their powers under section 125(2) and (3), so far as you are able, to provide certain information about interests in, and activities on, the land.
- 2. THE LAND TO WHICH THE NOTICE RELATES**
The land (hereinafter referred to as “the Site”) to which this Notice relates forms an area of land and premises now known as **Bluebell Lodge, Bardowie, East Dunbartonshire, G62 6EY** all as identified and edged in red on the Location Plan, noted as such, and attached and annexed to this Notice.
- 3. THE BREACH OF PLANNING CONTROL ALLEGED**
Without the required planning permission, the carrying out of development comprising of the following:

- (a) The unauthorised erection of a single storey building (cabin) – See **Photograph 1** of **Schedule 1**.
- (b) The unauthorised formation of a new access road and hardstanding,
- (c) The unauthorised erection of a timber screen fence,
- (d) The unauthorised erection of a boundary fence and gate,
- (e) The unauthorised erection of a log store structure – See **Photograph 2** of **Schedule 1**. and
- (f) The unauthorised siting of two freight storage containers sandwiching a timber storage structure which is being used for the storage of various building materials – See **Photograph 3** of **Schedule 1**.

4. INFORMATION REQUIRED

- (a) Provide in writing all details of any operations being carried out on the land and when they began, any use of the land including building(s) and any other activities being carried out on the land. For the avoidance of doubt, please include confirmation of the use of the single storey building (cabin).
- (b) State whether the land is being used for any purpose specified in the notice or any operations or activities specified in the notice are being or have been carried out on the land.
- (c) If in the response to questions (a) or (b) you state that a residential use occurs or has occurred on the site, please.
 - (i) State when this use began. If this was more than 10 years ago, evidence showing this should be provided.
 - (ii) Provide the full name(s) and address(s) of the persons who have resided and who currently reside in the property.
- (d) Give any information you hold as to any planning permission for any use or operations or any reason for planning permission not being required for any use or operation.
- (e) State the current owner(s) of the land and the date of purchase of the land.
- (f) State the nature of your interest (if any) in the land, your full name and designation together with contact details i.e. mobile telephone number and email address, and the names and addresses of any other persons with an interest in the land including a bank, building society, other lender, feu superior etc.

Time Period for Compliance:

This information must be provided in writing **within a period of 21 days from the date the notice is served on you.**

5. **WARNING**

It is an offence to fail, without reasonable excuse, to comply with any of the requirements of this notice within 21 days, beginning with the day on which it was served on you. The maximum penalty on conviction of this offence is a fine of **£5,000** (Level 5) on the standard scale. Continuing failure to comply following a conviction will constitute a further offence. It is also an offence to knowingly or recklessly give information in response to this notice, which is materially false or misleading. The maximum penalty on conviction of this is a fine of **£10,000** (statutory maximum).

If the Council serve a stop notice, under Section 140 of the Act, Section 143 (5) (b) of the Act provides that should you otherwise become entitled (under Section 143) to compensation for loss or damage attributable to that notice, no such compensation will be payable in respect of any loss or damage which could have been avoided had you given the Council the information required by this notice, or had you otherwise co-operated with the Council when responding to it.

Dated: 12 March 2026

Signed: *Heather Holland*

Heather Holland
Executive Officer – Land Planning & Development

On behalf of: **East Dunbartonshire Council**
Southbank House
Strathkelvin Place
Kirkintilloch
G66 1XQ

LOCATION PLAN

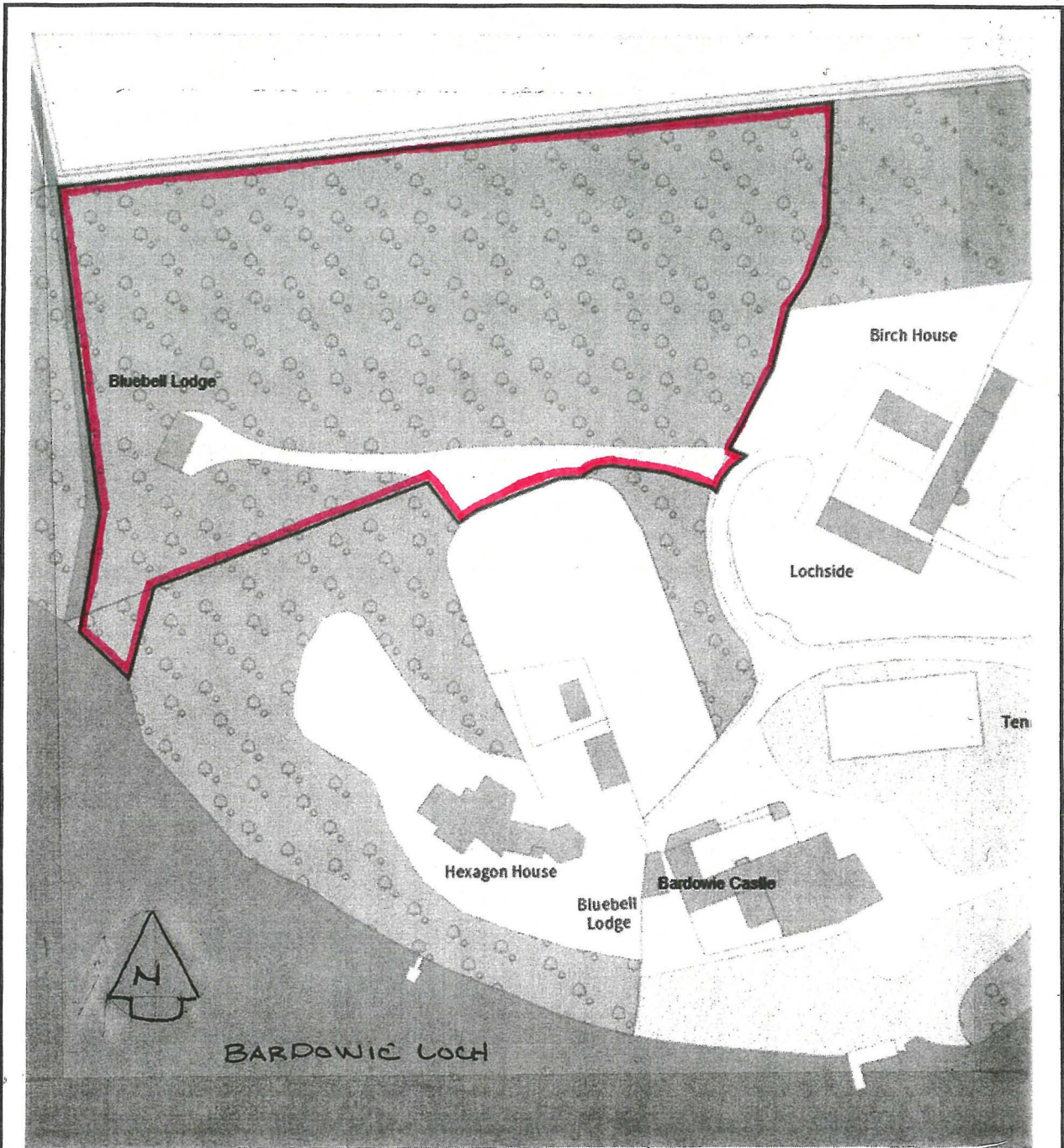

This is the Location Plan referred to in the foregoing **Planning Contravention Notice** served in accordance with the terms of Section 125 of the Town and Country Planning (Scotland) Act 1997 (as amended) relating to the land and premises now known as Bluebell Lodge, Bardowie, East Dunbartonshire, G62 6EY as shown edged in red.

Signed: *Heather Holland*

Dated: 12 March 2026

Heather Holland, **Executive Officer – Land Planning & Development**, on behalf of **East Dunbartonshire Council**. Southbank House. Strathkelvin Place. Kirkintilloch. G66 1XQ.

**PLANNING CONTRAVENTION NOTICE
(ED2022/0037/ENF)**

SCHEDULE 1

PHOTOGRAPHS



PHOTOGRAPH 1. The unauthorised erection of a single storey building (cabin) – “Bluebell Lodge”



PHOTOGRAPH 2. The unauthorised erection of a log store structure.



PHOTOGRAPH 3. The unauthorised siting of two freight storage containers sandwiching a timber storage structure which is being used for the storage of various building materials.