

SECTION 2

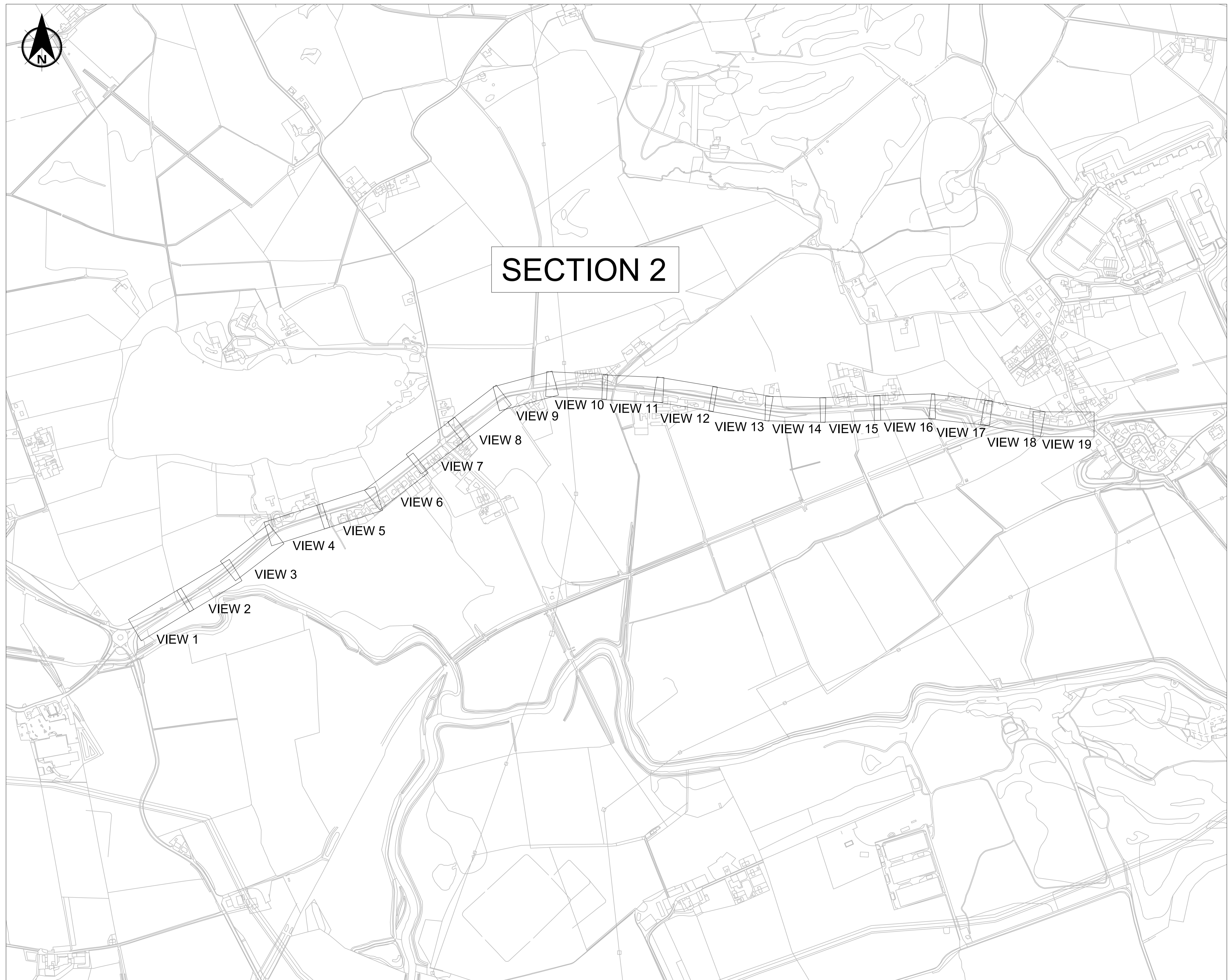
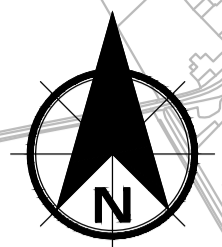

NOTES

1. DO NOT SCALE FROM THIS DRAWING MANUALLY OR ELECTRONICALLY.
2. THIS DRAWING IS TO BE READ IN CONJUNCTION WITH ALL OTHER RELEVANT PROJECT INFORMATION.
3. ALL DIMENSIONS ARE IN METRES UNLESS OTHERWISE STATED.

Rev	Date	Amendment Details	CS	MH	AB
0	15/11/2023	FIRST ISSUE			

2nd Floor, Quay 2
 139 Fountainbridge
 Edinburgh
 EH3 9QG
 Tel: +44 (0)131 550 6300
 Web: www.sweco.co.uk



Client

EAST DUNBARTONSHIRE COUNCIL

Project Title

A807 - TORRANCE TO MILNGAVIE

Drawing Title

LOCATION PLAN SECTION 2

Purpose Of Issue
PRELIMINARY

Status	INITIAL STATUS OR WIP			
S0	CS	CS	MH	AB
Drawn	Designed	Checked	Approved	
Sheet Size	Scale	Sweco Ref	Revision	
A1	1:5	65211230	P01	

Drawing Number
211230-SWE-ATT-00-D-AT-0050

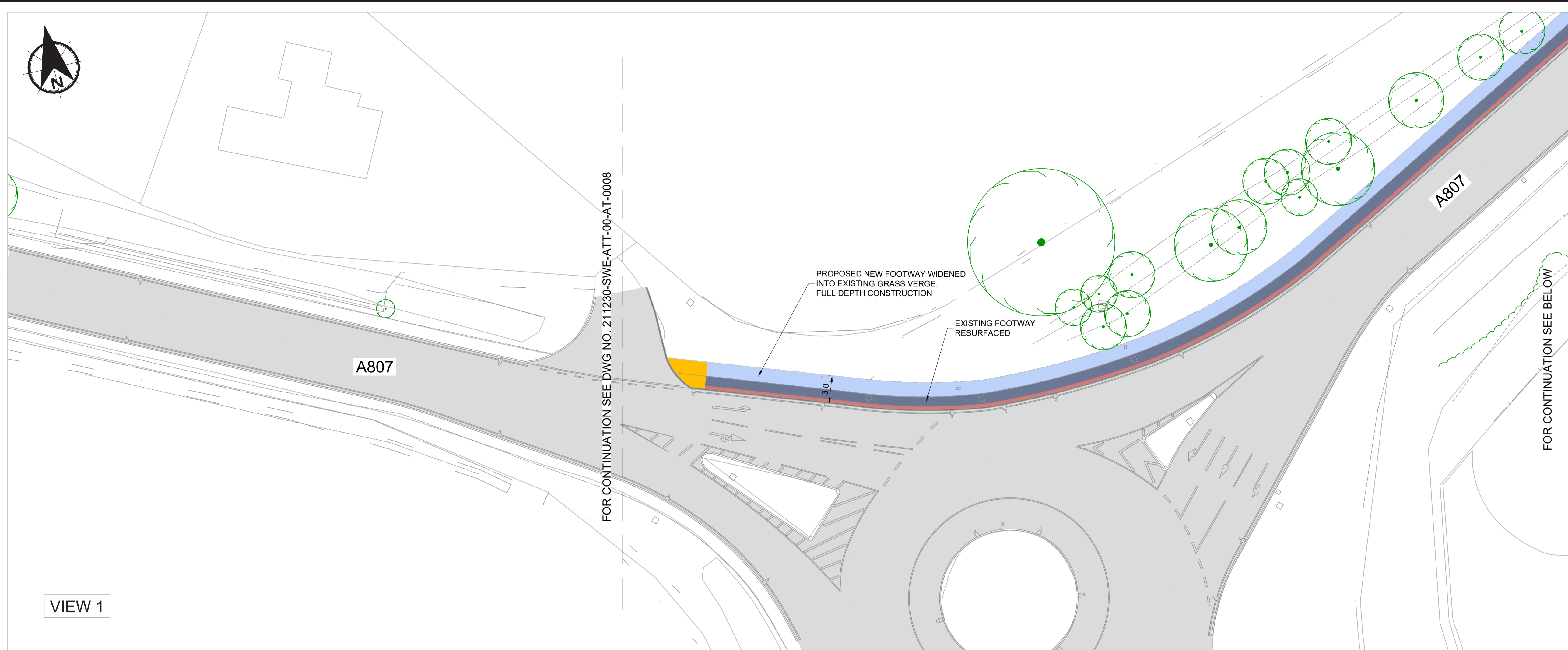

VIEW 1

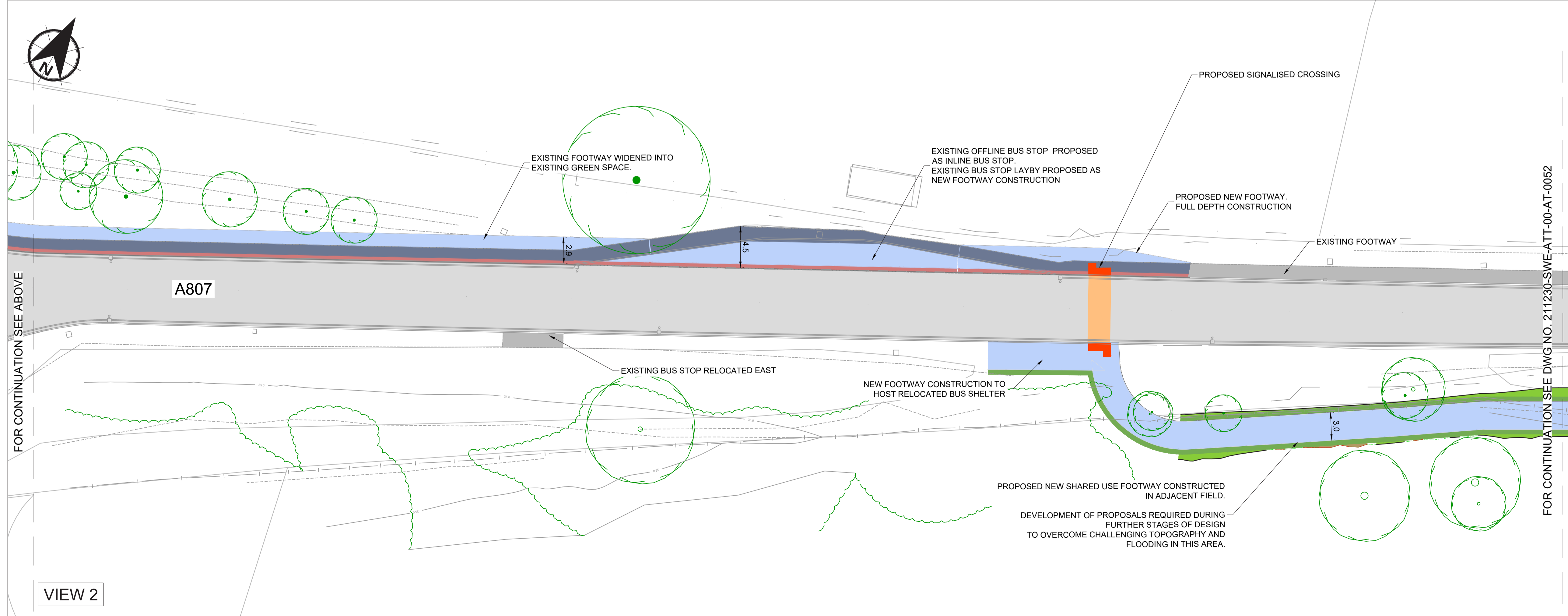

VIEW 2

NOTES

- DO NOT SCALE FROM THIS DRAWING MANUALLY OR ELECTRONICALLY.
- THIS DRAWING IS TO BE READ IN CONJUNCTION WITH ALL OTHER RELEVANT PROJECT INFORMATION.
- ALL DIMENSIONS ARE IN METRES UNLESS OTHERWISE STATED.

KEY

PROPOSED NEW FOOTWAY CONSTRUCTION	
EXISTING FOOTWAY - RESURFACING	
HIGH FRICTION BUFFER STRIP	
EXISTING CARRIAGEWAY	
EXISTING FOOTWAY	
TACTILE PAVING - CONTROLLED CROSSING	
TACTILE PAVING - UNCONTROLLED CROSSING	
EXISTING/PROPOSED VERGE	
ENGINEERING CUT	
ENGINEERING FILL	
EXISTING VRS TO BE RETAINED	
EXISTING TREES	
SHARED USE FOOTWAY USERS PRIORITY OVER JUNCTION TO BE INVESTIGATED	

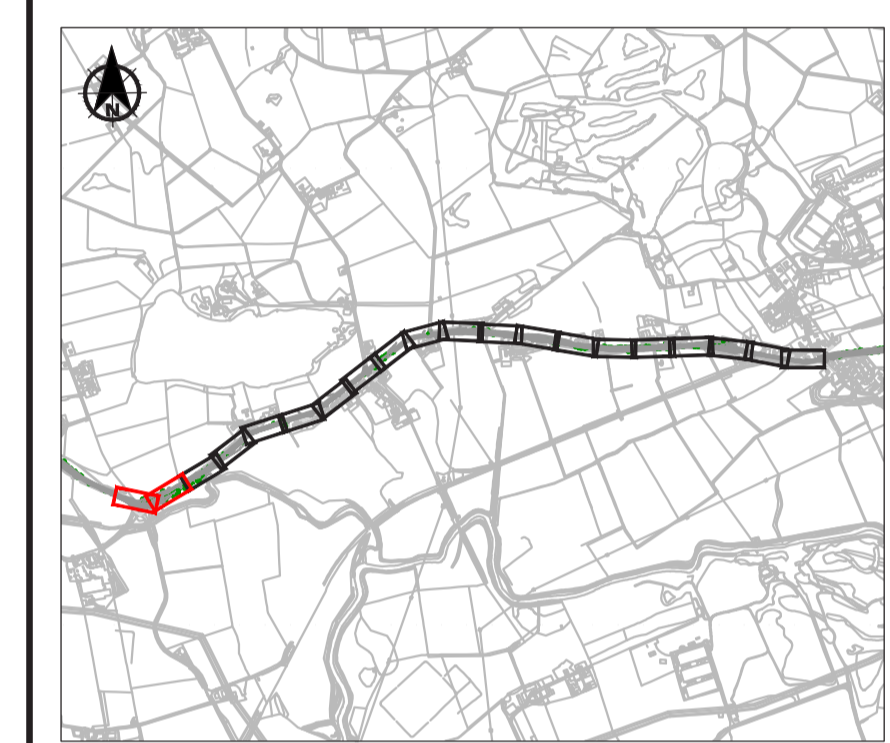

P02	08/04/2024	POST CONSULTATION	CS	MH	AB
P01	21/12/2023	POST EDC REVIEW	CS	MH	AB
0	24/11/2023	FIRST ISSUE	CS	MH	AB
Rev	Date	Amendment Details	Dr'n	Chk'	App'

2nd Floor, Quay 2
139 Fountainbridge
Edinburgh
EH3 9QG
Tel: +44 (0)131 550 6300
Web: www.sweco.co.uk



Client

EAST DUNBARTONSHIRE COUNCIL

Project Title

A807 - TORRANCE TO MILNGAVIE

Drawing Title

SECTION 2
GENERAL ARRANGEMENT
SHEET 1 OF 10

Purpose Of Issue
PRELIMINARY

Status	S0	Status Description	INITIAL STATUS OR WIP
--------	----	--------------------	-----------------------

Drawn	CS	Designed	CS	Checked	MH	Approved	AB
-------	----	----------	----	---------	----	----------	----

Sheet Size	A1	Scale	1:250	Sweco Ref	65211230	Revision	P02
------------	----	-------	-------	-----------	----------	----------	-----

Drawing Number
211230-SWE-ATT-00-D-AT-0051

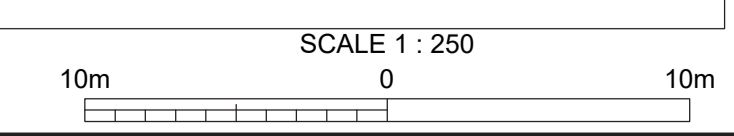



FOR CONTINUATION SEE DWG NO. 211230-SWE-ATT-00-AT-0051

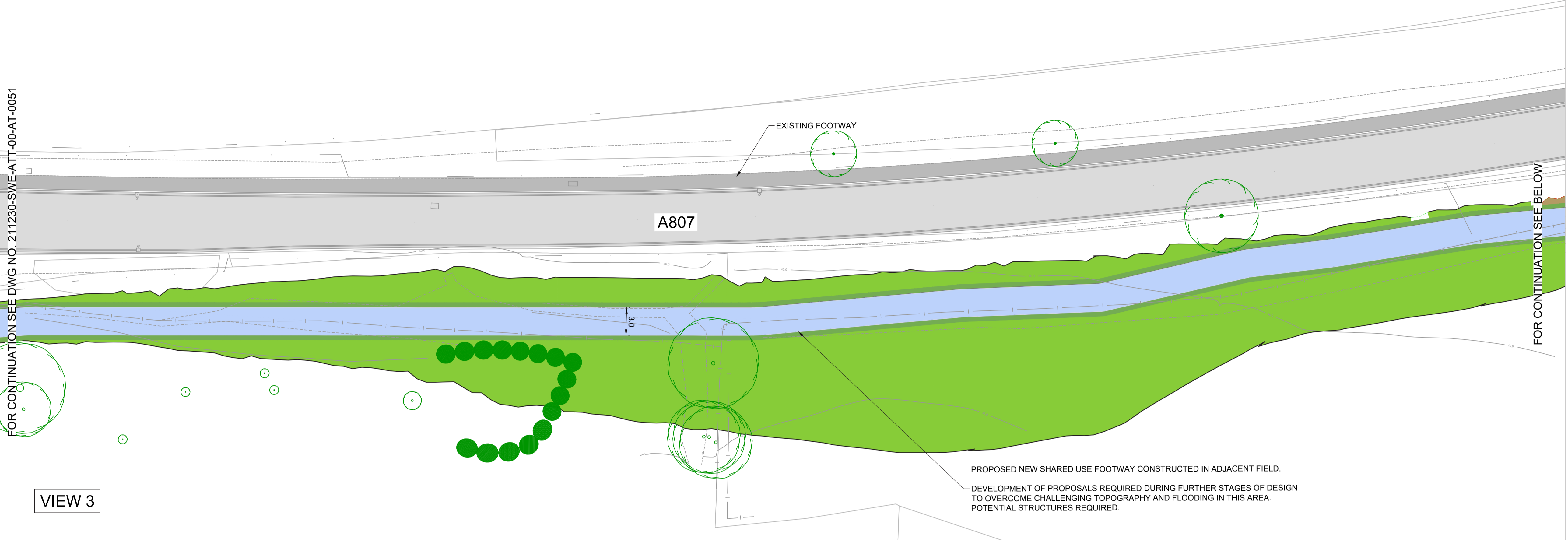

VIEW 3

PROPOSED NEW SHARED USE FOOTWAY CONSTRUCTED IN ADJACENT FIELD.
 DEVELOPMENT OF PROPOSALS REQUIRED DURING FURTHER STAGES OF DESIGN
 TO OVERCOME CHALLENGING TOPOGRAPHY AND FLOODING IN THIS AREA.
 POTENTIAL STRUCTURES REQUIRED.



FOR CONTINUATION SEE ABOVE

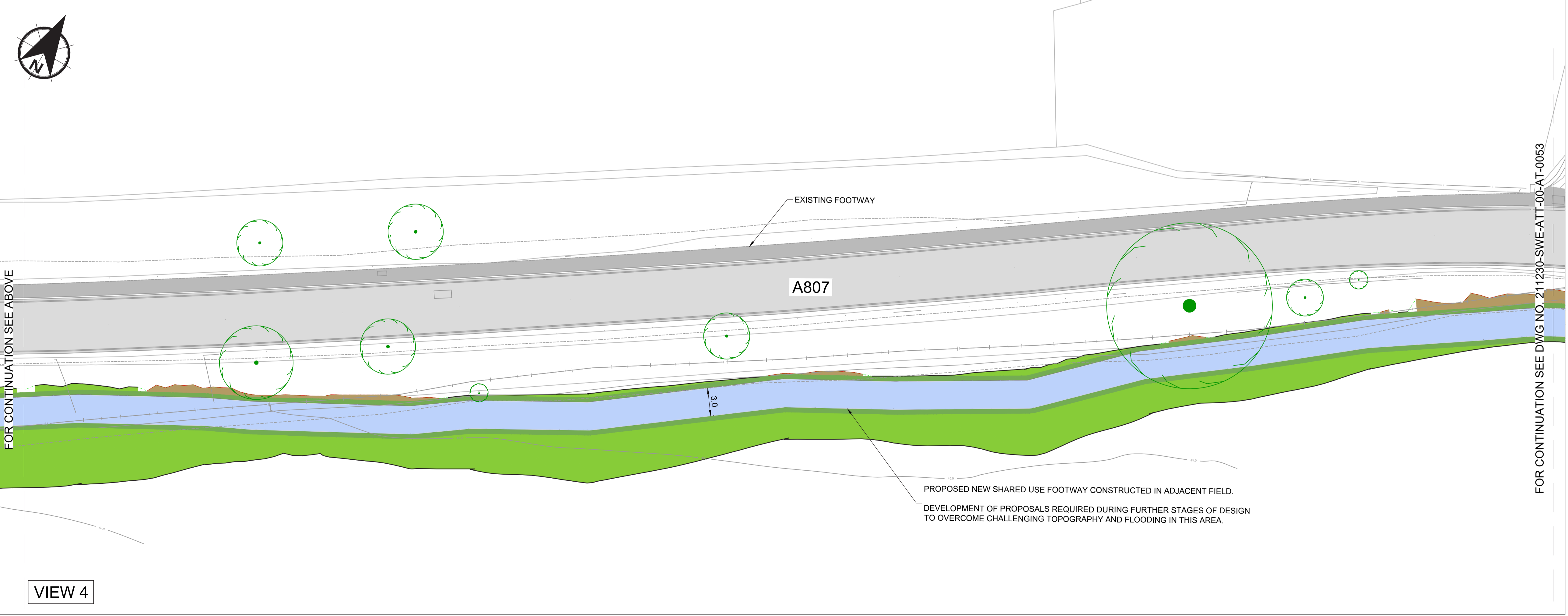

VIEW 4

PROPOSED NEW SHARED USE FOOTWAY CONSTRUCTED IN ADJACENT FIELD.
 DEVELOPMENT OF PROPOSALS REQUIRED DURING FURTHER STAGES OF DESIGN
 TO OVERCOME CHALLENGING TOPOGRAPHY AND FLOODING IN THIS AREA.

NOTES

- DO NOT SCALE FROM THIS DRAWING MANUALLY OR ELECTRONICALLY.
- THIS DRAWING IS TO BE READ IN CONJUNCTION WITH ALL OTHER RELEVANT PROJECT INFORMATION.
- ALL DIMENSIONS ARE IN METRES UNLESS OTHERWISE STATED.

KEY

PROPOSED NEW FOOTWAY CONSTRUCTION	[Blue line]
EXISTING FOOTWAY - RESURFACING	[Dark grey line]
HIGH FRICTION BUFFER STRIP	[Red line]
EXISTING CARRIAGEWAY	[Light grey line]
EXISTING FOOTWAY	[Dark grey line]
TACTILE PAVING - CONTROLLED CROSSING	[Orange line]
TACTILE PAVING - UNCONTROLLED CROSSING	[Red line]
EXISTING/PROPOSED VERGE	[Green line]
ENGINEERING CUT	[Brown line]
ENGINEERING FILL	[Light green line]
EXISTING VRS TO BE RETAINED	[Blue line]
EXISTING TREES	[Green circle]
SHARED USE FOOTWAY USERS PRIORITY OVER JUNCTION TO BE INVESTIGATED	[Red rectangle]

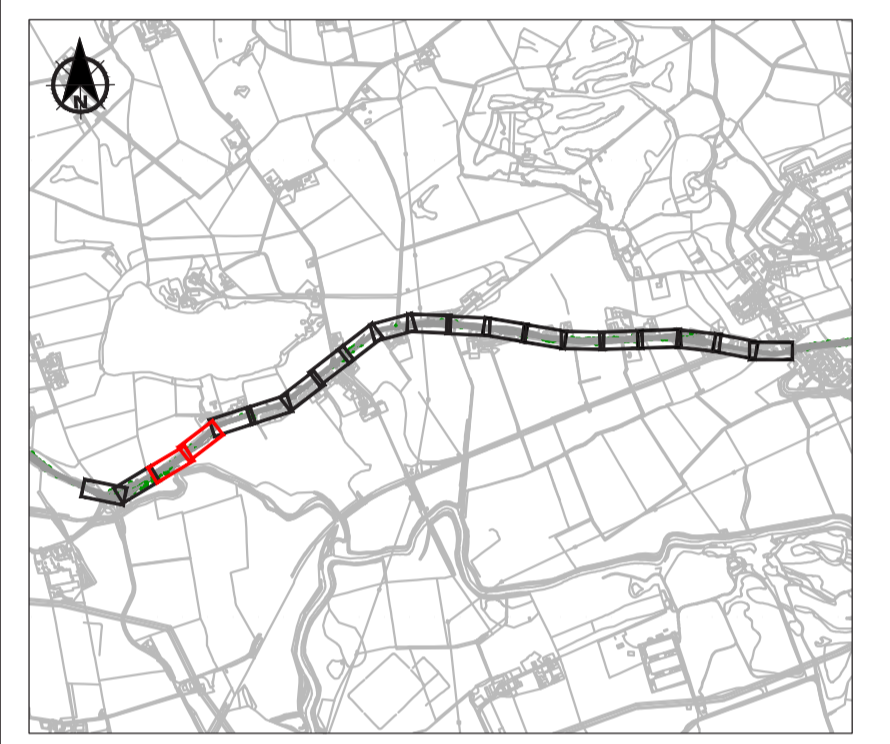

P02	08/04/2024	POST CONSULTATION	CS	MH	AB
P01	21/12/2023	POST EDC REVIEW	CS	MH	AB
0	24/11/2023	FIRST ISSUE	CS	MH	AB
Rev	Date	Amendment Details	Dr'n	Chk'	App'

2nd Floor, Quay 2
 139 Fountainbridge
 Edinburgh
 EH3 9QG
 Tel: +44 (0)131 550 6300
 Web: www.sweco.co.uk



Client
EAST DUNBARTONSHIRE COUNCIL

Project Title
A807 - TORRANCE TO MILNGAVIE

Drawing Title
**SECTION 2
 GENERAL ARRANGEMENT
 SHEET 2 OF 10**

Purpose Of Issue
PRELIMINARY

Status	S0 INITIAL STATUS OR WIP						
Drawn	CS	Designed	CS	Checked	MH	Approved	AB
Sheet Size	A1	Scale	1:250	Sweco Ref	65211230	Revision	P02

Drawing Number
211230-SWE-ATT-00-D-AT-0052

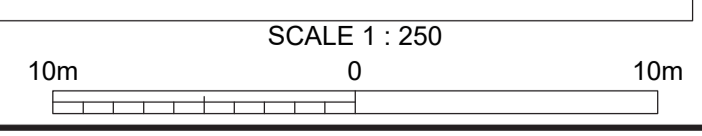

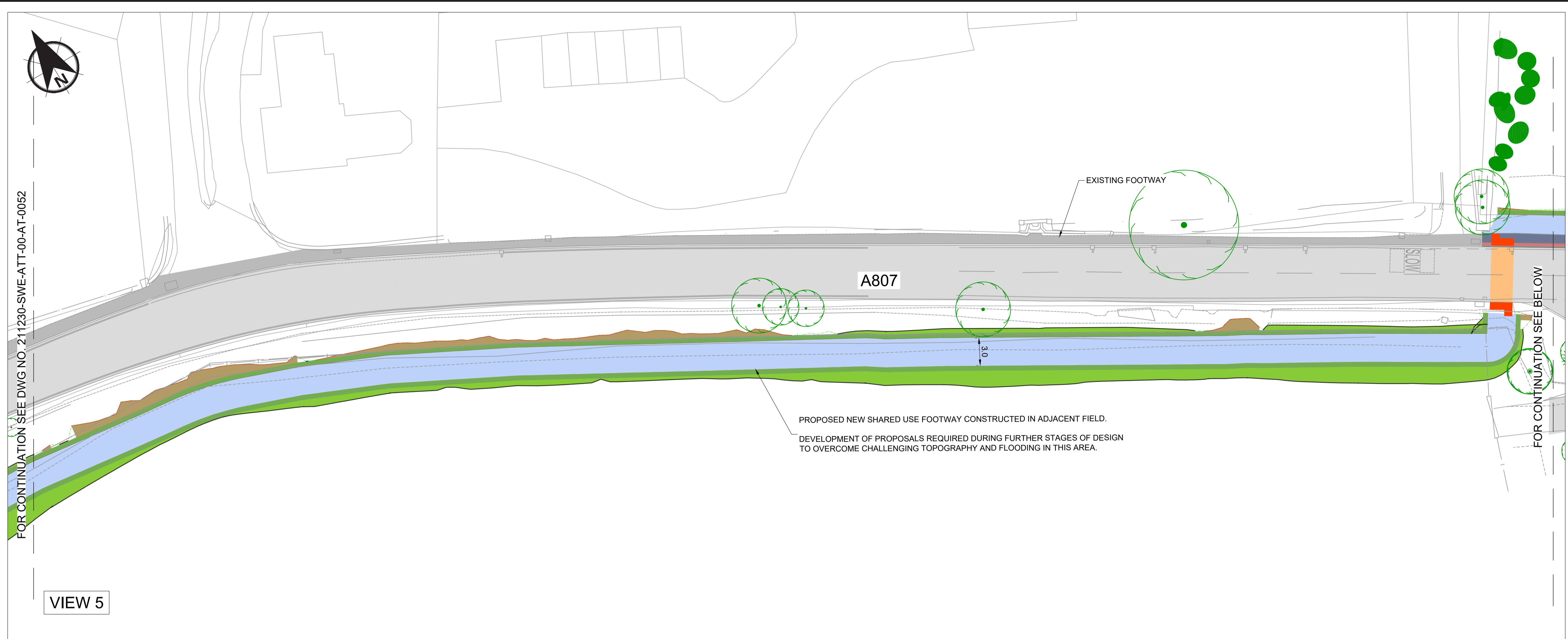

VIEW 5

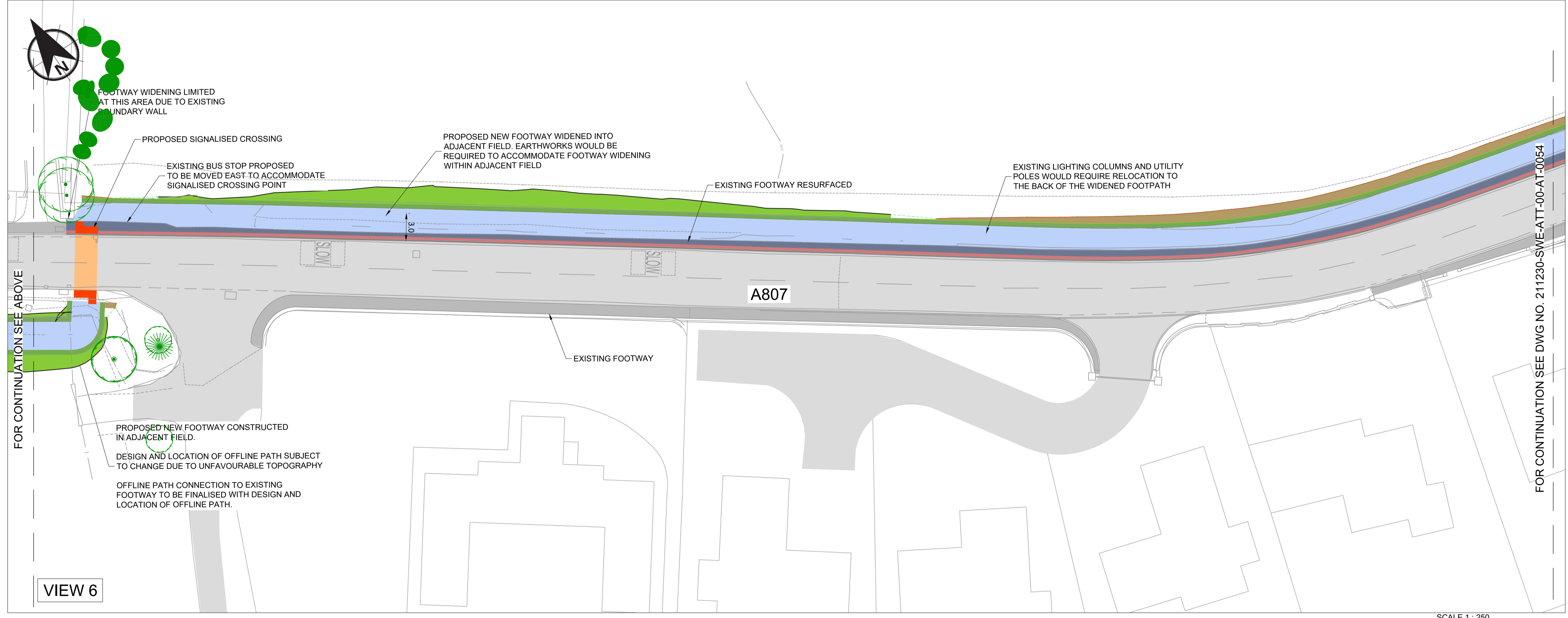

VIEW 6

NOTES

- DO NOT SCALE FROM THIS DRAWING MANUALLY OR ELECTRONICALLY.
- THIS DRAWING IS TO BE READ IN CONJUNCTION WITH ALL OTHER RELEVANT PROJECT INFORMATION.
- ALL DIMENSIONS ARE IN METRES UNLESS OTHERWISE STATED.

KEY

PROPOSED NEW FOOTWAY CONSTRUCTION	
EXISTING FOOTWAY - RESURFACING	
HIGH FRICTION BUFFER STRIP	
EXISTING CARRIAGEWAY	
EXISTING FOOTWAY	
TACTILE PAVING - CONTROLLED CROSSING	
TACTILE PAVING - UNCONTROLLED CROSSING	
EXISTING/PROPOSED VERGE	
ENGINEERING CUT	
ENGINEERING FILL	
EXISTING VRS TO BE RETAINED	
EXISTING TREES	
SHARED USE FOOTWAY USERS PRIORITY OVER JUNCTION TO BE INVESTIGATED	

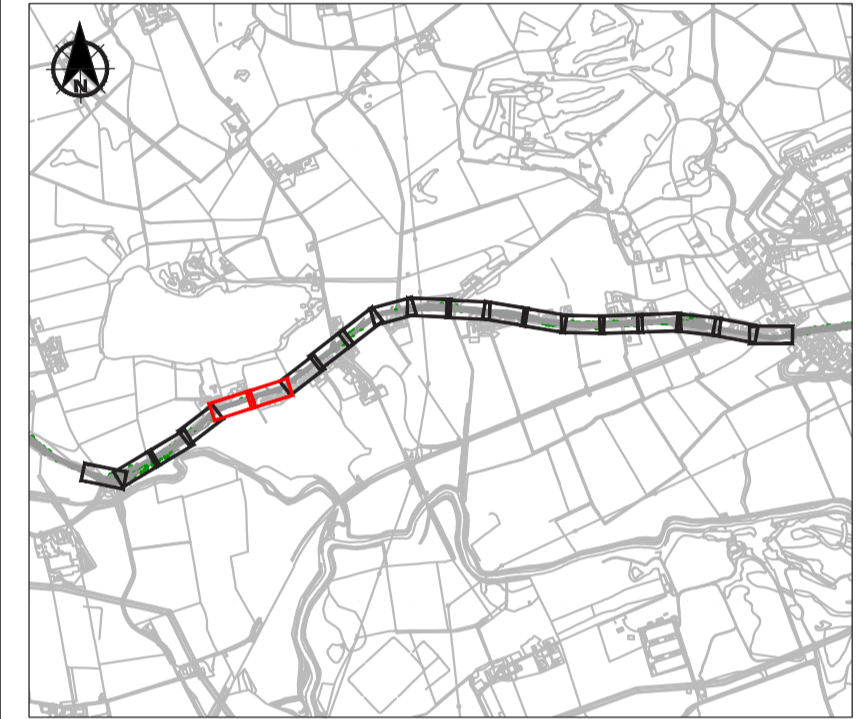

P02	08/04/2024	POST CONSULTATION	CS	MH	AB
P01	21/12/2023	POST EDC REVIEW	CS	MH	AB
0	24/11/2023	FIRST ISSUE	CS	MH	AB
Rev	Date	Amendment Details	Dr'n	Chk'	App'

2nd Floor, Quay 2
139 Fountainbridge
Edinburgh
EH3 9QG
Tel: +44 (0)131 550 6300
Web: www.sweco.co.uk



Client
EAST DUNBARTONSHIRE COUNCIL

Project Title
A807 - TORRANCE TO MILNGAVIE

Drawing Title
**SECTION 2
GENERAL ARRANGEMENT
SHEET 3 OF 10**

Purpose Of Issue
PRELIMINARY

Status	S0 INITIAL STATUS OR WIP			
Drawn	Designed	Checked	Approved	
CS	CS	MH	AB	
Sheet Size	Scale	Sweco Ref	Revision	
A1	1:250	65211230	P02	

Drawing Number
211230-SWE-ATT-00-D-AT-0053

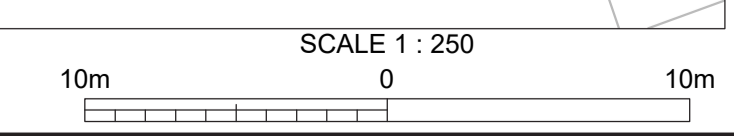

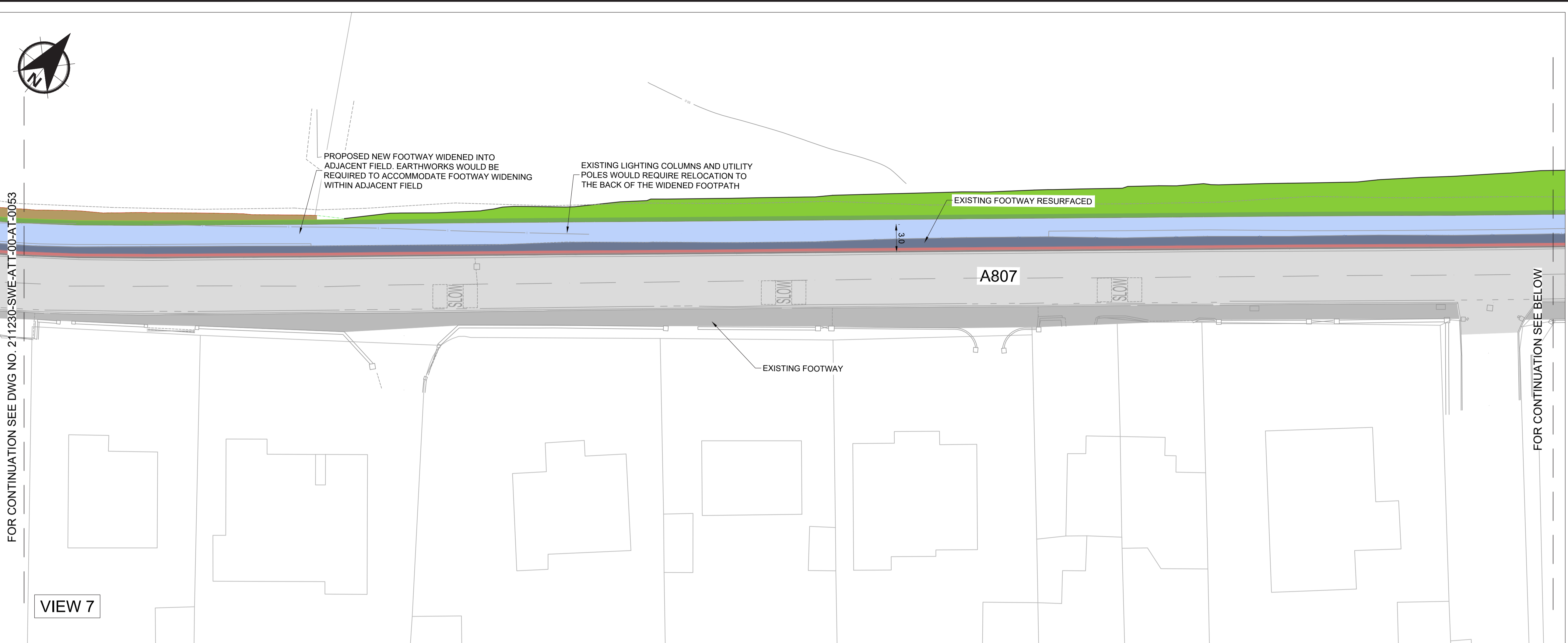

VIEW 7

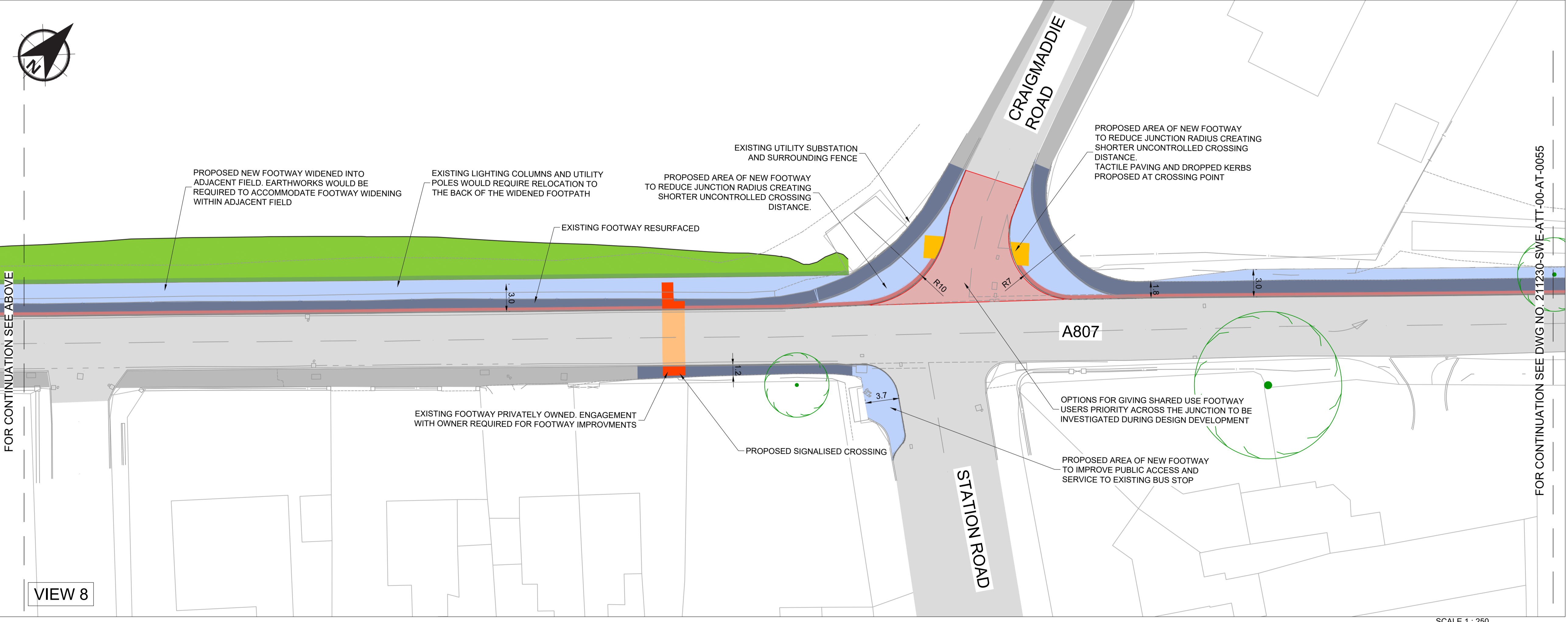

VIEW 8

NOTES

- DO NOT SCALE FROM THIS DRAWING MANUALLY OR ELECTRONICALLY.
- THIS DRAWING IS TO BE READ IN CONJUNCTION WITH ALL OTHER RELEVANT PROJECT INFORMATION.
- ALL DIMENSIONS ARE IN METRES UNLESS OTHERWISE STATED.

KEY

PROPOSED NEW FOOTWAY CONSTRUCTION	
EXISTING FOOTWAY - RESURFACING	
HIGH FRICTION BUFFER STRIP	
EXISTING CARRIAGEWAY	
EXISTING FOOTWAY	
TACTILE PAVING - CONTROLLED CROSSING	
TACTILE PAVING - UNCONTROLLED CROSSING	
EXISTING/PROPOSED VERGE	
ENGINEERING CUT	
ENGINEERING FILL	
EXISTING VRS TO BE RETAINED	
EXISTING TREES	
SHARED USE FOOTWAY USERS PRIORITY OVER JUNCTION TO BE INVESTIGATED	

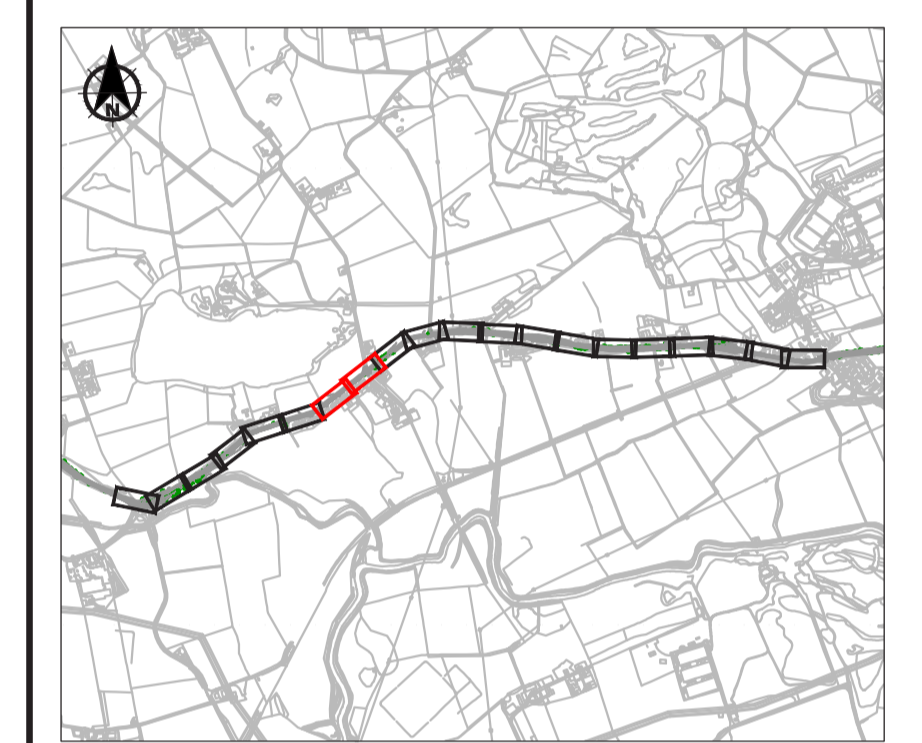

P02	08/04/2024	POST CONSULTATION	CS	MH	AB
P01	21/12/2023	POST EDC REVIEW	CS	MH	AB
0	24/11/2023	FIRST ISSUE	CS	MH	AB
Rev	Date	Amendment Details	Dr'n	Chk'	App'

2nd Floor, Quay 2
139 Fountainbridge
Edinburgh
EH3 9QG
Tel: +44 (0)131 550 6300
Web: www.sweco.co.uk



Client
EAST DUNBARTONSHIRE COUNCIL

Project Title
A807 - TORRANCE TO MILNGAVIE

Drawing Title
**SECTION 2
GENERAL ARRANGEMENT
SHEET 4 OF 10**

Purpose Of Issue
PRELIMINARY

Status	S0 INITIAL STATUS OR WIP			
Drawn	CS	CS	MH	AB
Sheet Size	A1	Scale	1:250	Sweco Ref
			65211230	Revision
				P02

Drawing Number
211230-SWE-ATT-00-D-AT-0054



FOR CONTINUATION SEE DWG NO. 211230-SWE-ATT-00-AT-0054

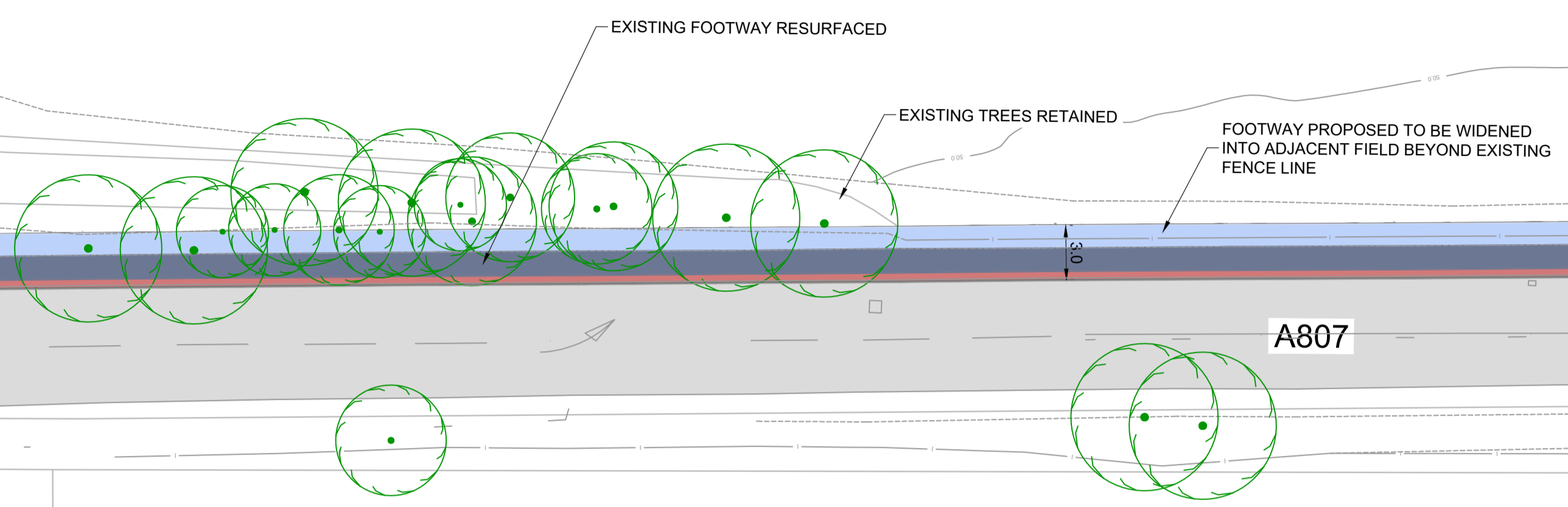

VIEW 9

FOR CONTINUATION SEE BELOW



FOR CONTINUATION SEE ABOVE

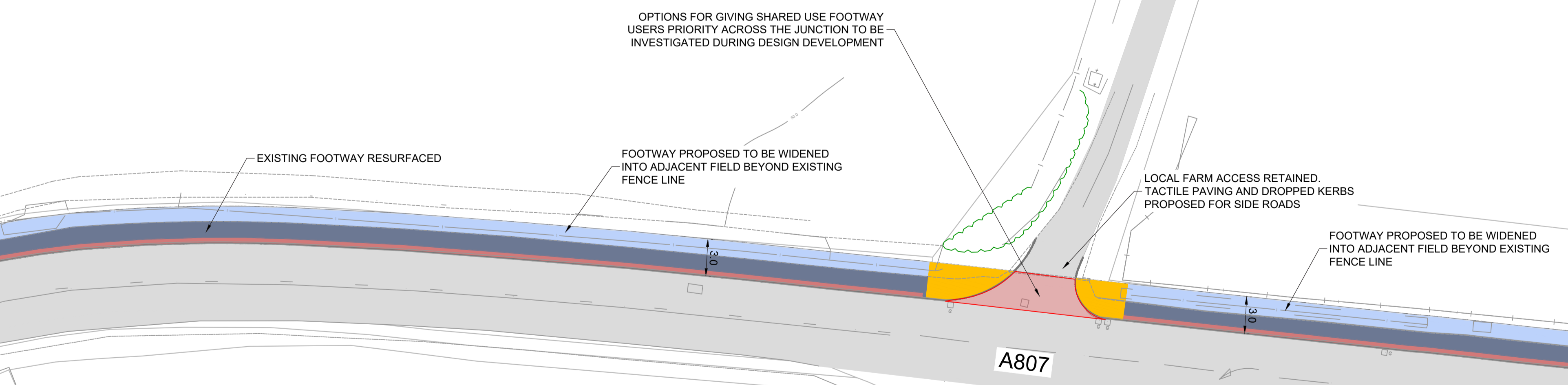

VIEW 10

FOR CONTINUATION SEE DWG NO. 211230-SWE-ATT-00-AT-0056

NOTES

- DO NOT SCALE FROM THIS DRAWING MANUALLY OR ELECTRONICALLY.
- THIS DRAWING IS TO BE READ IN CONJUNCTION WITH ALL OTHER RELEVANT PROJECT INFORMATION.
- ALL DIMENSIONS ARE IN METRES UNLESS OTHERWISE STATED.

KEY

- PROPOSED NEW FOOTWAY CONSTRUCTION
- EXISTING FOOTWAY - RESURFACING
- HIGH FRICTION BUFFER STRIP
- EXISTING CARRIAGEWAY
- EXISTING FOOTWAY
- TACTILE PAVING - CONTROLLED CROSSING
- TACTILE PAVING - UNCONTROLLED CROSSING
- EXISTING/PROPOSED VERGE
- ENGINEERING CUT
- ENGINEERING FILL
- EXISTING VRS TO BE RETAINED
- EXISTING TREES
- SHARED USE FOOTWAY USERS PRIORITY OVER JUNCTION TO BE INVESTIGATED

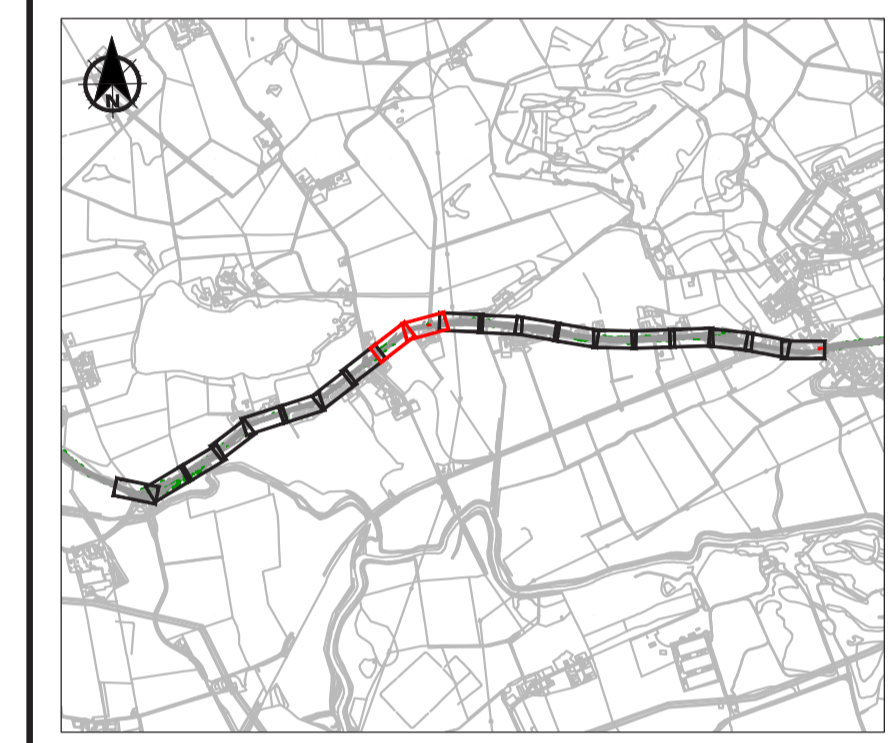

P02	08/04/2024	POST CONSULTATION	CS	MH	AB
P01	21/12/2023	POST EDC REVIEW	CS	MH	AB
0	24/11/2023	FIRST ISSUE	CS	MH	AB
Rev	Date	Amendment Details	Dr'n	Chk'	App'

2nd Floor, Quay 2
 139 Fountainbridge
 Edinburgh
 EH3 9QG
 Tel: +44 (0)131 550 6300
 Web: www.sweco.co.uk



Client
EAST DUNBARTONSHIRE COUNCIL

Project Title
A807 - TORRANCE TO MILNGAVIE

Drawing Title
**SECTION 2
 GENERAL ARRANGEMENT
 SHEET 5 OF 10**

Purpose Of Issue
PRELIMINARY

Status	INITIAL STATUS OR WIP			
S0	Designed	Checked	Approved	
CS	CS	MH	AB	
Sheet Size	Scale	Sweco Ref	Revision	
A1	1:250	65211230	P02	

Drawing Number
211230-SWE-ATT-00-D-AT-0055

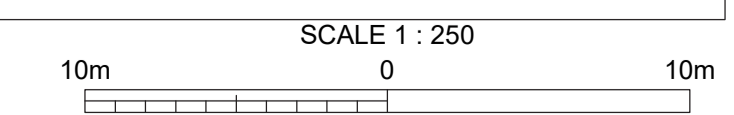

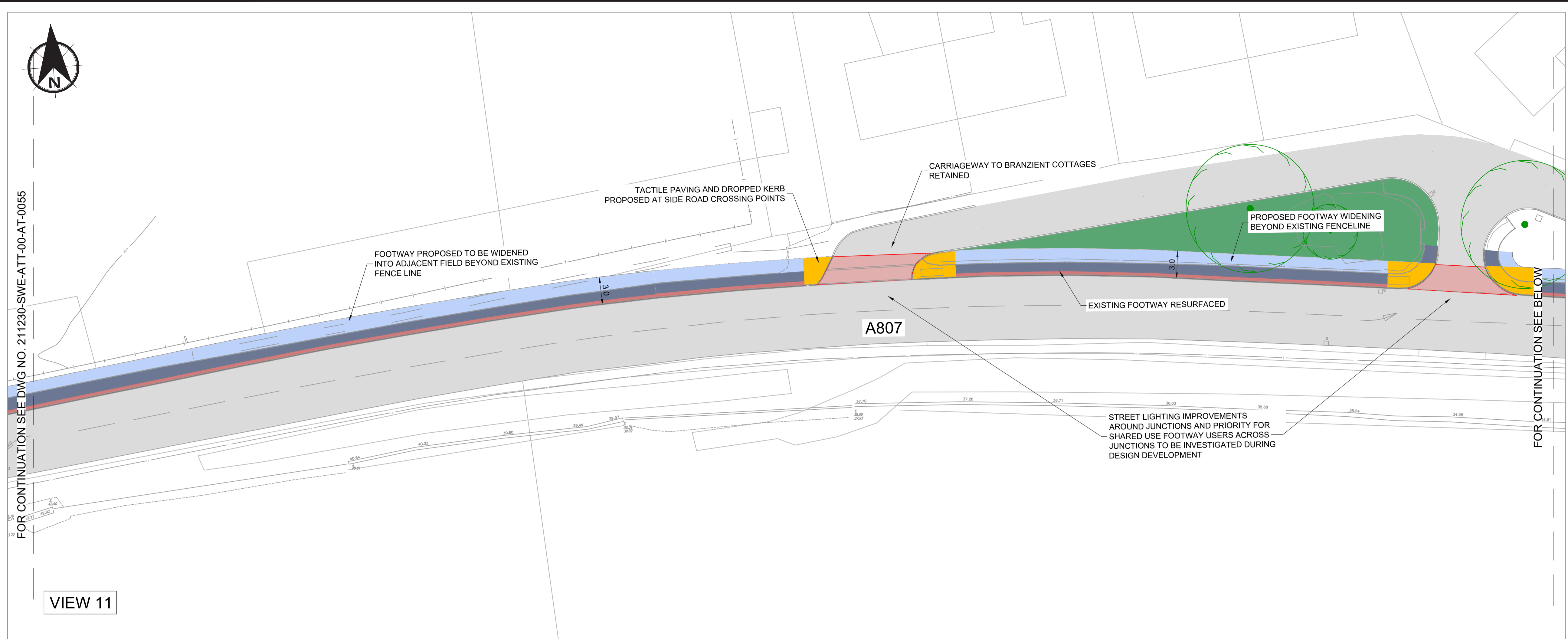

VIEW 11

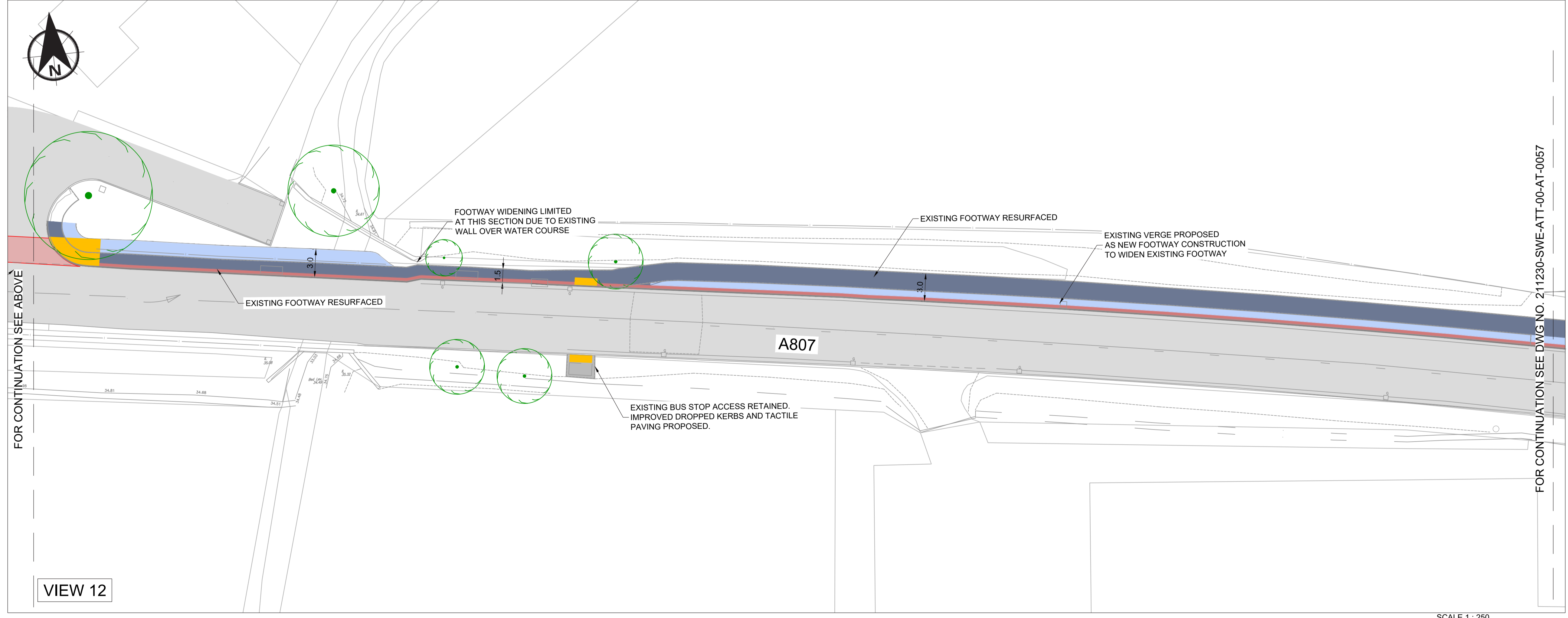

VIEW 12

NOTES

- DO NOT SCALE FROM THIS DRAWING MANUALLY OR ELECTRONICALLY.
- THIS DRAWING IS TO BE READ IN CONJUNCTION WITH ALL OTHER RELEVANT PROJECT INFORMATION.
- ALL DIMENSIONS ARE IN METRES UNLESS OTHERWISE STATED.

KEY

PROPOSED NEW FOOTWAY CONSTRUCTION	
EXISTING FOOTWAY - RESURFACING	
HIGH FRICTION BUFFER STRIP	
EXISTING CARRIAGEWAY	
EXISTING FOOTWAY	
TACTILE PAVING - CONTROLLED CROSSING	
TACTILE PAVING - UNCONTROLLED CROSSING	
EXISTING/PROPOSED VERGE	
ENGINEERING CUT	
ENGINEERING FILL	
EXISTING VRS TO BE RETAINED	
EXISTING TREES	
SHARED USE FOOTWAY USERS PRIORITY OVER JUNCTION TO BE INVESTIGATED	

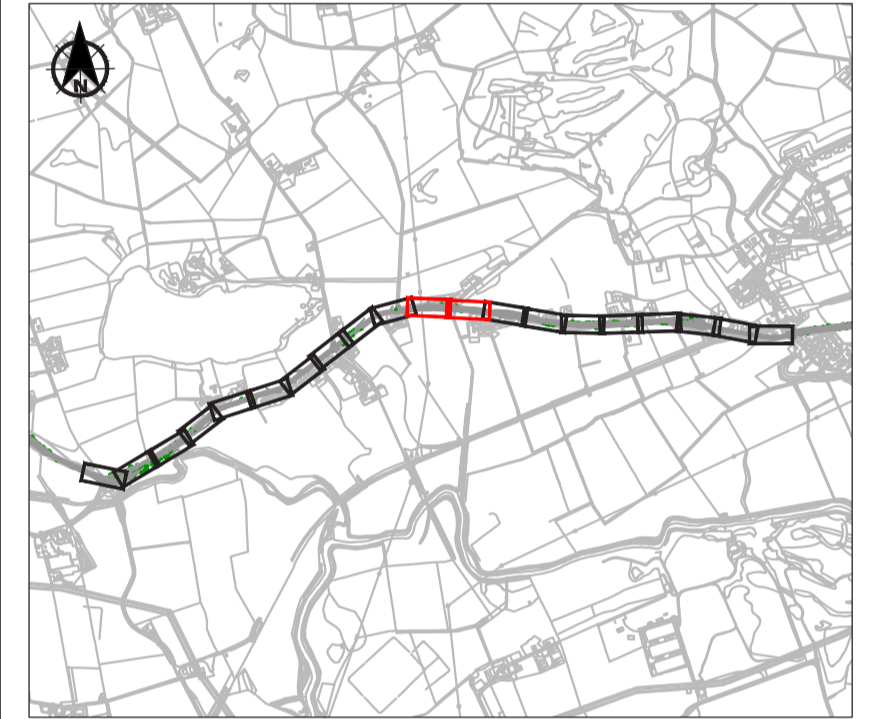

P02	08/04/2024	POST CONSULTATION	CS	MH	AB
P01	21/12/2023	POST EDC REVIEW	CS	MH	AB
0	24/11/2023	FIRST ISSUE	CS	MH	AB
Rev	Date	Amendment Details	Dr'n	Chk'	App'

2nd Floor, Quay 2
139 Fountainbridge
Edinburgh
EH3 9QG
Tel: +44 (0)131 550 6300
Web: www.sweco.co.uk



Client
EAST DUNBARTONSHIRE COUNCIL

Project Title
A807 - TORRANCE TO MILNGAVIE

Drawing Title
**SECTION 2
GENERAL ARRANGEMENT
SHEET 6 OF 10**

Purpose Of Issue PRELIMINARY			
Status	S0 INITIAL STATUS OR WIP		
Drawn	Designed	Checked	Approved
CS	CS	MH	AB
Sheet Size	Scale	Sweco Ref	Revision
A1	1:250	65211230	P02

Drawing Number
211230-SWE-ATT-00-D-AT-0056

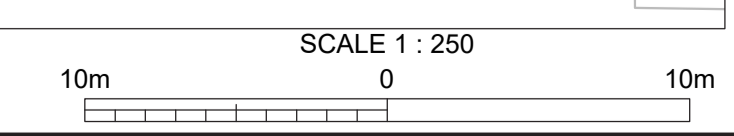



FOR CONTINUATION SEE DWG NO. 211230-SWE-ATT-00-AT-0056

VIEW 13

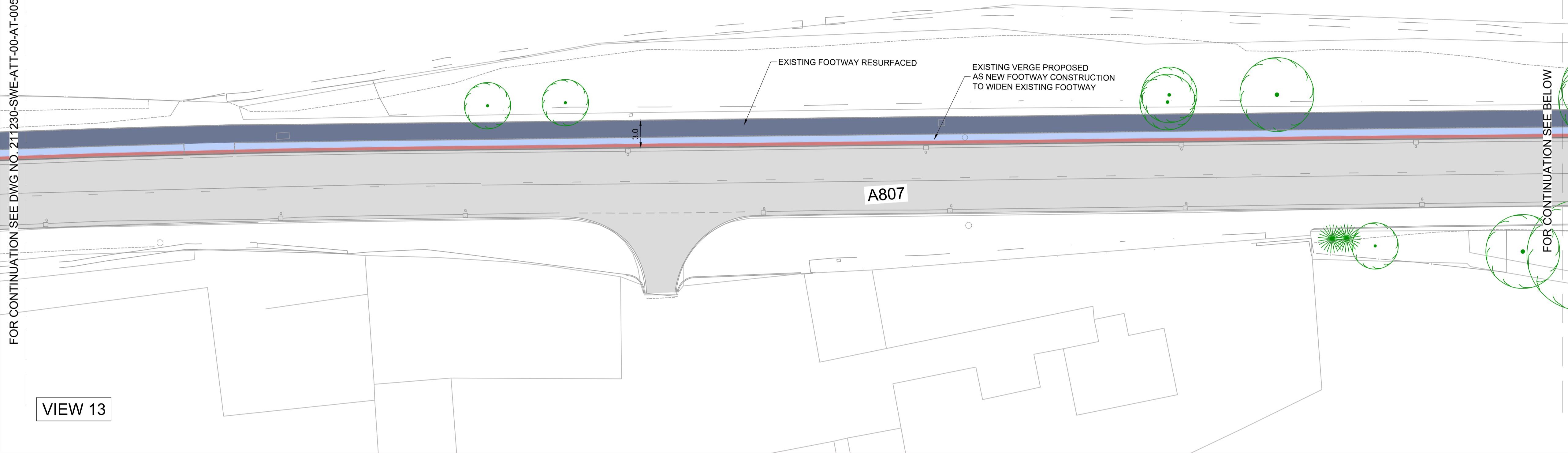

FOR CONTINUATION SEE BELOW



FOR CONTINUATION SEE ABOVE

VIEW 14

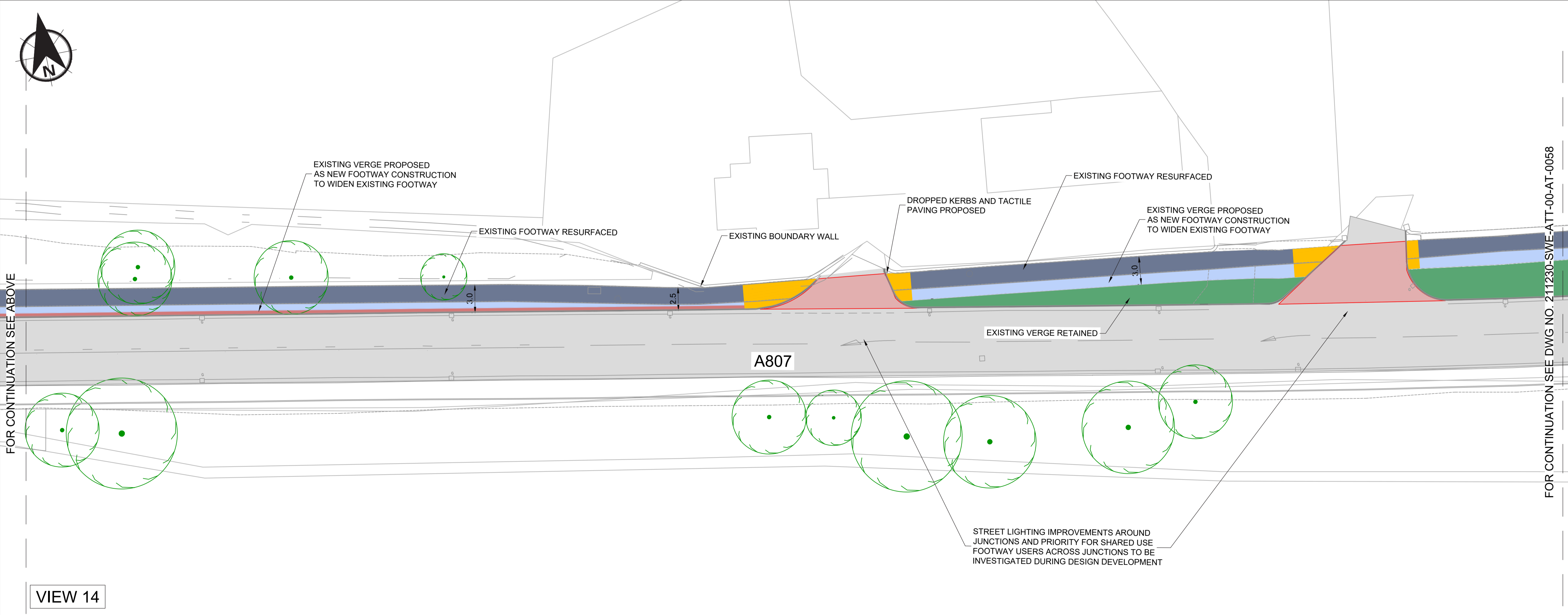

FOR CONTINUATION SEE DWG NO. 211230-SWE-ATT-00-AT-0058

NOTES

- DO NOT SCALE FROM THIS DRAWING MANUALLY OR ELECTRONICALLY.
- THIS DRAWING IS TO BE READ IN CONJUNCTION WITH ALL OTHER RELEVANT PROJECT INFORMATION.
- ALL DIMENSIONS ARE IN METRES UNLESS OTHERWISE STATED.

KEY

- PROPOSED NEW FOOTWAY CONSTRUCTION
- EXISTING FOOTWAY - RESURFACING
- HIGH FRICTION BUFFER STRIP
- EXISTING CARRIAGEWAY
- EXISTING FOOTWAY
- TACTILE PAVING - CONTROLLED CROSSING
- TACTILE PAVING - UNCONTROLLED CROSSING
- EXISTING/PROPOSED VERGE
- ENGINEERING CUT
- ENGINEERING FILL
- EXISTING VRS TO BE RETAINED
- EXISTING TREES
- SHARED USE FOOTWAY USERS PRIORITY OVER JUNCTION TO BE INVESTIGATED

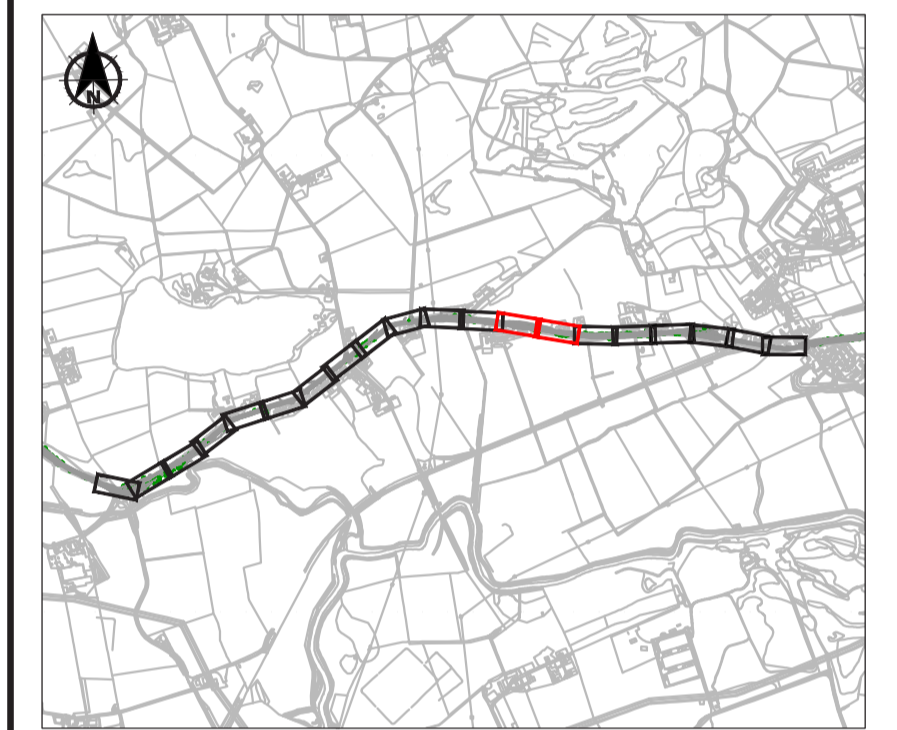

P02	08/04/2024	POST CONSULTATION	CS	MH	AB
P01	21/12/2023	POST EDC REVIEW	CS	MH	AB
0	24/11/2023	FIRST ISSUE	CS	MH	AB
Rev	Date	Amendment Details	Dr'n	Chk'	App'

2nd Floor, Quay 2
 139 Fountainbridge
 Edinburgh
 EH3 9QG
 Tel: +44 (0)131 550 6300
 Web: www.sweco.co.uk



Client

EAST DUNBARTONSHIRE COUNCIL

Project Title

A807 - TORRANCE TO MILNGAVIE

Drawing Title

SECTION 2
GENERAL ARRANGEMENT
SHEET 7 OF 10

Purpose Of Issue

PRELIMINARY

Status	INITIAL STATUS OR WIP			
S0				

Drawn	Designed	Checked	Approved
CS	CS	MH	AB
Sheet Size	Scale	Sweco Ref	Revision
A1	1:250	65211230	P02

Drawing Number

211230-SWE-ATT-00-D-AT-0057

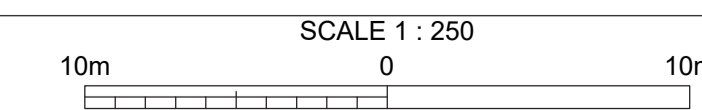

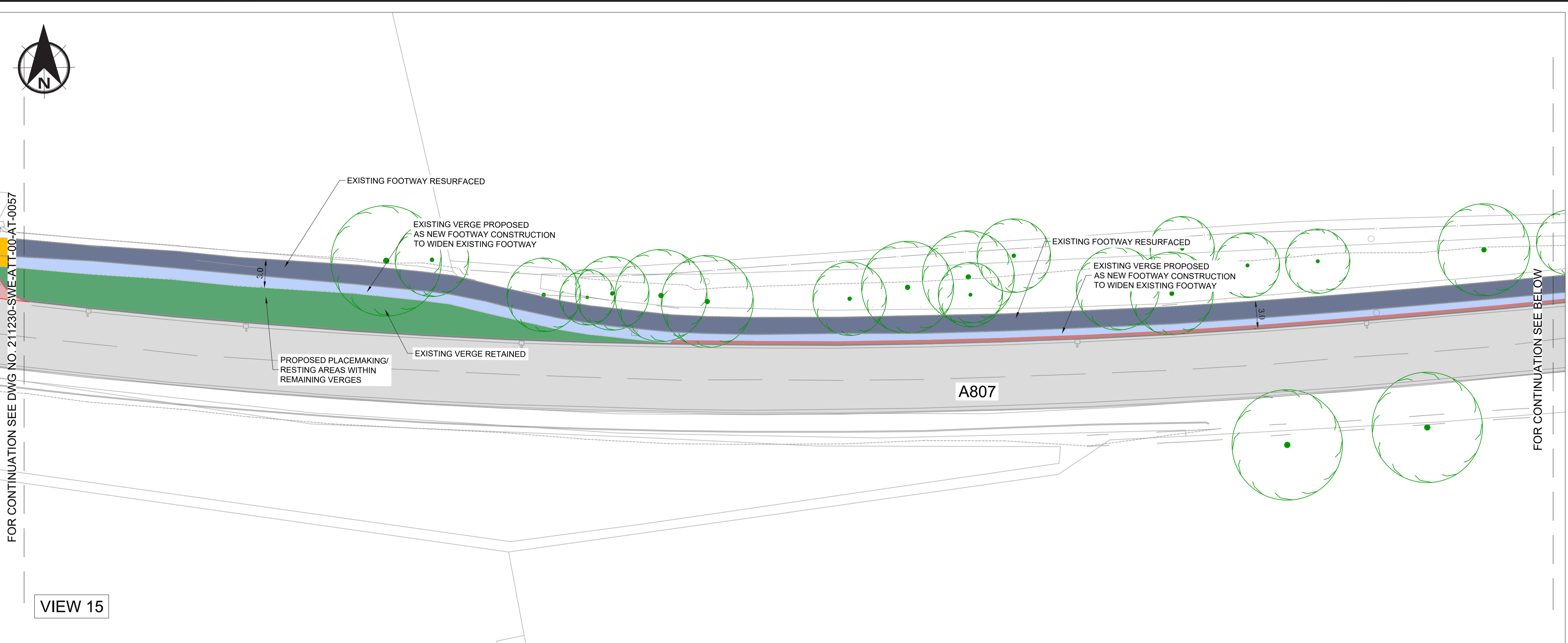

VIEW 15

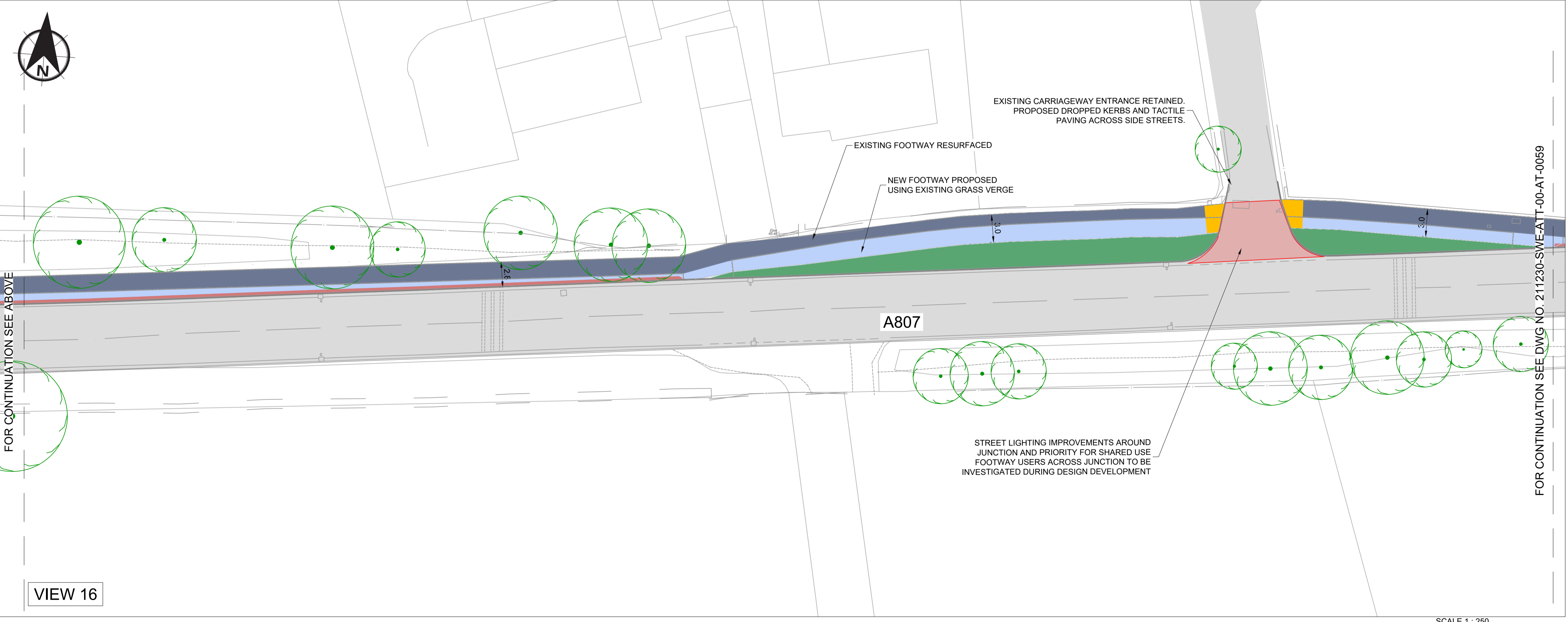

VIEW 16

NOTES

- DO NOT SCALE FROM THIS DRAWING MANUALLY OR ELECTRONICALLY.
- THIS DRAWING IS TO BE READ IN CONJUNCTION WITH ALL OTHER RELEVANT PROJECT INFORMATION.
- ALL DIMENSIONS ARE IN METRES UNLESS OTHERWISE STATED.

KEY

PROPOSED NEW FOOTWAY CONSTRUCTION	
EXISTING FOOTWAY - RESURFACING	
HIGH FRICTION BUFFER STRIP	
EXISTING CARRIAGEWAY	
EXISTING FOOTWAY	
TACTILE PAVING - CONTROLLED CROSSING	
TACTILE PAVING - UNCONTROLLED CROSSING	
EXISTING/PROPOSED VERGE	
ENGINEERING CUT	
ENGINEERING FILL	
EXISTING VRS TO BE RETAINED	
EXISTING TREES	
SHARED USE FOOTWAY USERS PRIORITY OVER JUNCTION TO BE INVESTIGATED	

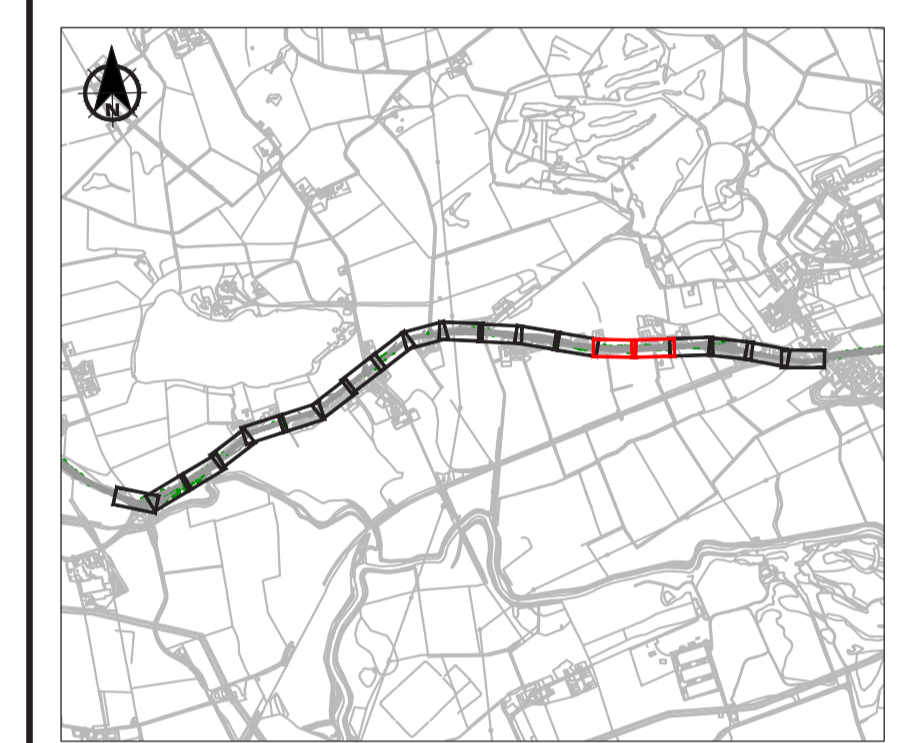

P02	08/04/2024	POST CONSULTATION	CS	MH	AB
P01	21/12/2023	POST EDC REVIEW	CS	MH	AB
0	24/11/2023	FIRST ISSUE	CS	MH	AB
Rev	Date	Amendment Details	Dr'n	Chk'	App'

2nd Floor, Quay 2
139 Fountainbridge
Edinburgh
EH3 9QG
Tel: +44 (0)131 550 6300
Web: www.sweco.co.uk

Client
EAST DUNBARTONSHIRE COUNCIL

Project Title
A807 - TORRANCE TO MILNGAVIE

Drawing Title
**SECTION 2
GENERAL ARRANGEMENT
SHEET 8 OF 10**

Purpose Of Issue
PRELIMINARY

Status	S0 INITIAL STATUS OR WIP			
Drawn	CS	CS	MH	AB
Sheet Size	A1	Scale	1:250	Sweco Ref
			65211230	Revision
				P02

Drawing Number
211230-SWE-ATT-00-D-AT-0058

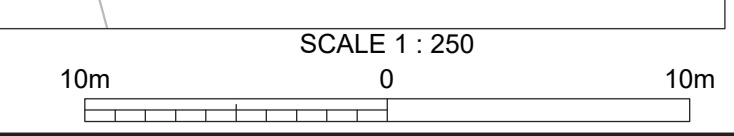

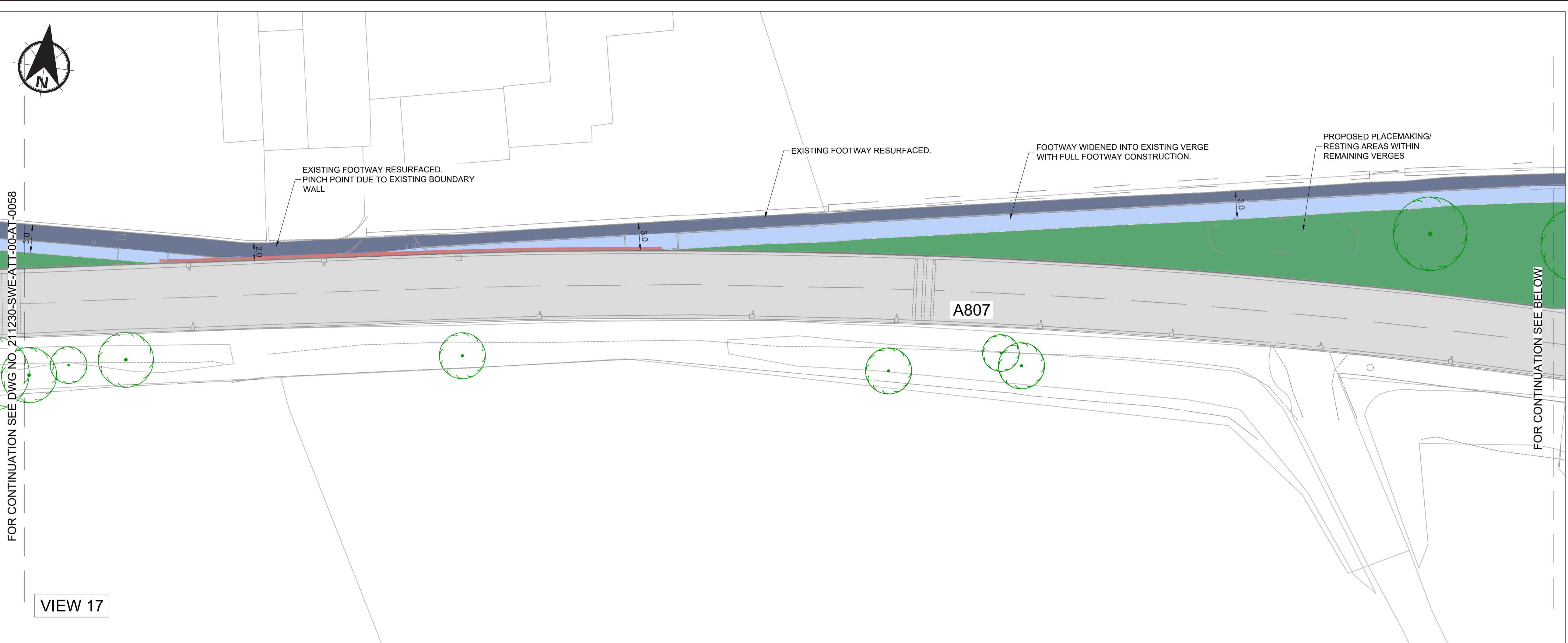

VIEW 17



VIEW 18

NOTES

- DO NOT SCALE FROM THIS DRAWING MANUALLY OR ELECTRONICALLY.
- THIS DRAWING IS TO BE READ IN CONJUNCTION WITH ALL OTHER RELEVANT PROJECT INFORMATION.
- ALL DIMENSIONS ARE IN METRES UNLESS OTHERWISE STATED.

KEY

PROPOSED NEW FOOTWAY CONSTRUCTION	
EXISTING FOOTWAY - RESURFACING	
HIGH FRICTION BUFFER STRIP	
EXISTING CARRIAGEWAY	
EXISTING FOOTWAY	
TACTILE PAVING - CONTROLLED CROSSING	
TACTILE PAVING - UNCONTROLLED CROSSING	
EXISTING/PROPOSED VERGE	
ENGINEERING CUT	
ENGINEERING FILL	
EXISTING VRS TO BE RETAINED	
EXISTING TREES	
SHARED USE FOOTWAY USERS PRIORITY OVER JUNCTION TO BE INVESTIGATED	

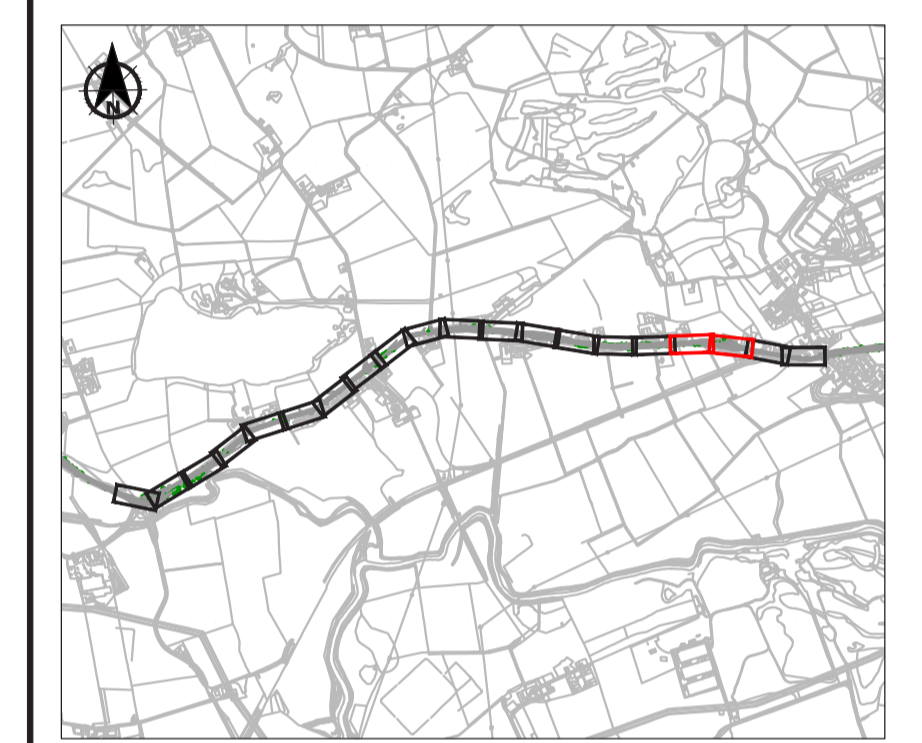

P02	08/04/2024	POST CONSULTATION	CS	MH	AB
P01	21/12/2023	POST EDC REVIEW	CS	MH	AB
0	24/11/2023	FIRST ISSUE	CS	MH	AB
Rev	Date	Amendment Details	Dr'n	Chk'	App'

2nd Floor, Quay 2
139 Fountainbridge
Edinburgh
EH3 9QG
Tel: +44 (0)131 550 6300
Web: www.sweco.co.uk

Client
EAST DUNBARTONSHIRE COUNCIL

Project Title
A807 - TORRANCE TO MILNGAVIE

Drawing Title
**SECTION 2
GENERAL ARRANGEMENT
SHEET 9 OF 10**

Purpose Of Issue PRELIMINARY							
Status	S0 INITIAL STATUS OR WIP						
Drawn	CS	Designed	CS	Checked	MH	Approved	AB
Sheet Size	A1	Scale	1:250	Sweco Ref	65211230	Revision	P02
Drawing Number 211230-SWE-ATT-00-D-AT-0059							

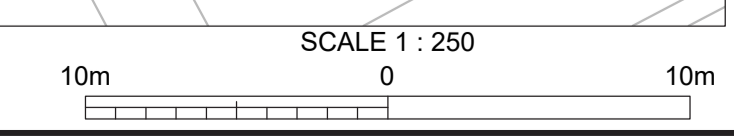

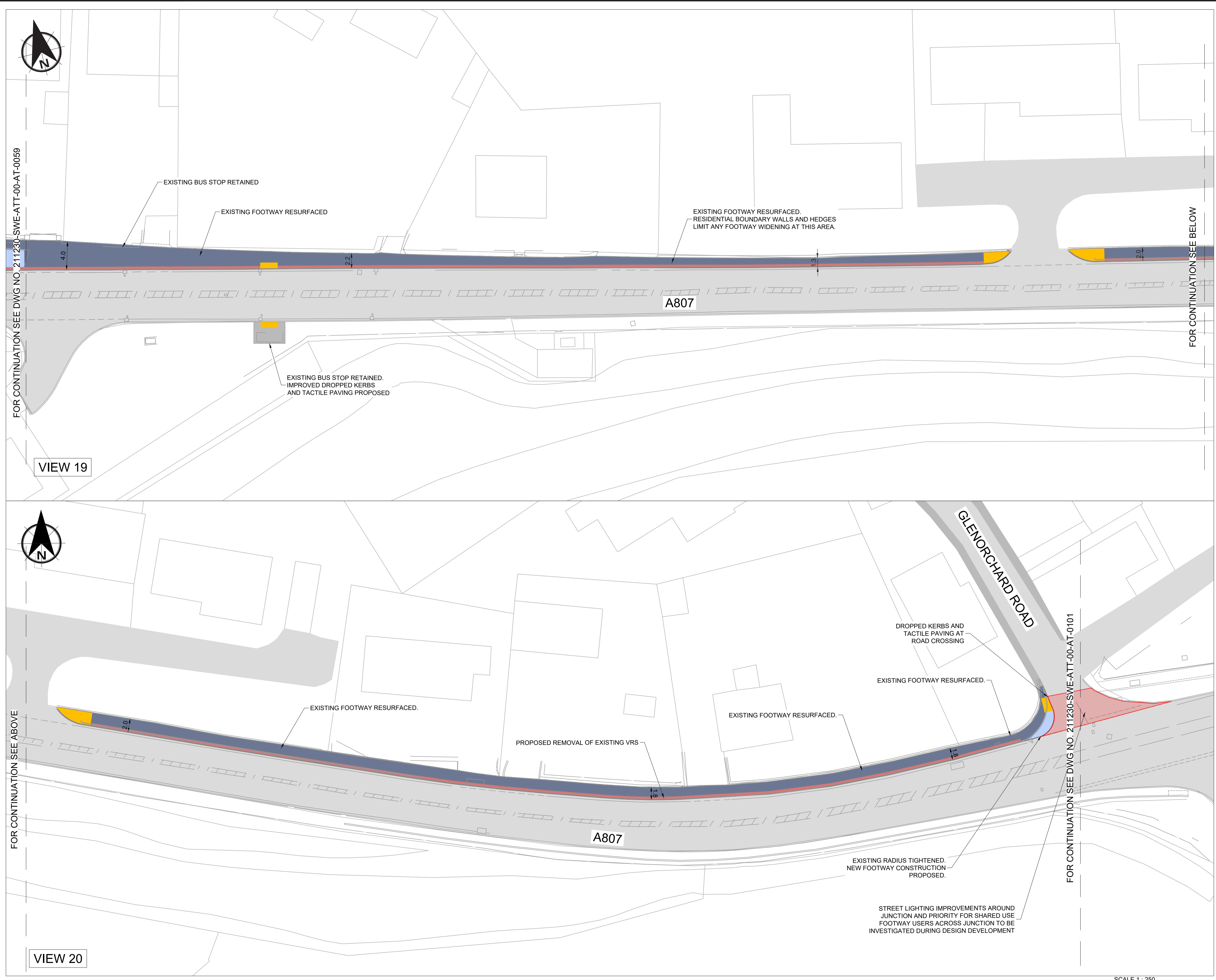

NOTES

- DO NOT SCALE FROM THIS DRAWING MANUALLY OR ELECTRONICALLY.
- THIS DRAWING IS TO BE READ IN CONJUNCTION WITH ALL OTHER RELEVANT PROJECT INFORMATION.
- ALL DIMENSIONS ARE IN METRES UNLESS OTHERWISE STATED.

KEY

PROPOSED NEW FOOTWAY CONSTRUCTION	
EXISTING FOOTWAY - RESURFACING	
HIGH FRICTION BUFFER STRIP	
EXISTING CARRIAGEWAY	
EXISTING FOOTWAY	
TACTILE PAVING - CONTROLLED CROSSING	
TACTILE PAVING - UNCONTROLLED CROSSING	
EXISTING/PROPOSED VERGE	
ENGINEERING CUT	
ENGINEERING FILL	
EXISTING VRS TO BE RETAINED	
EXISTING TREES	
SHARED USE FOOTWAY USERS PRIORITY OVER JUNCTION TO BE INVESTIGATED	

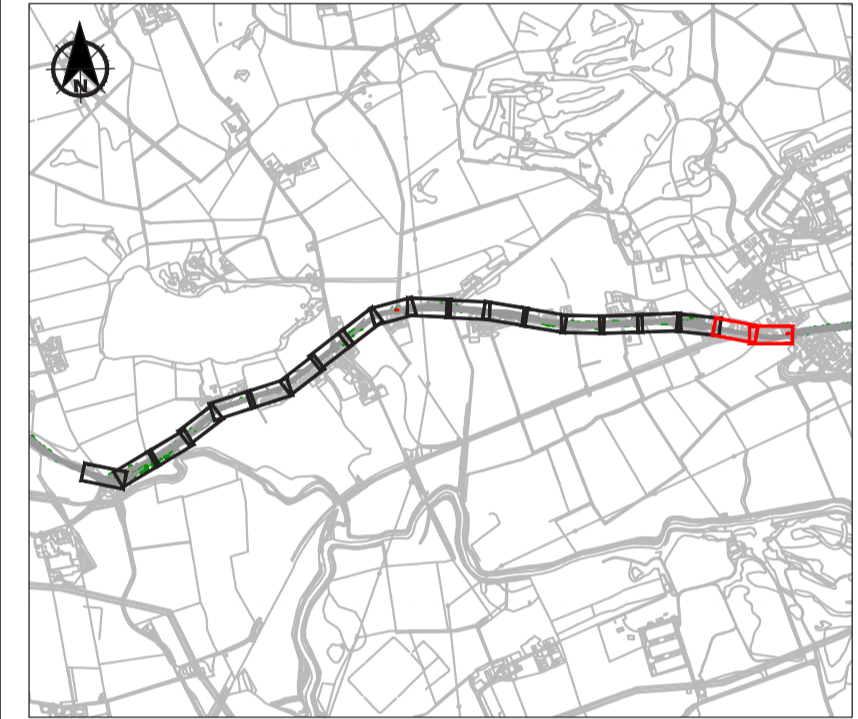

P02	08/04/2024	POST CONSULTATION	CS	MH	AB
P01	21/12/2023	POST EDC REVIEW	CS	MH	AB
0	24/11/2023	FIRST ISSUE	CS	MH	AB
Rev	Date	Amendment Details	Dr'n	Chk'	App'

2nd Floor, Quay 2
139 Fountainbridge
Edinburgh
EH3 9QG
Tel: +44 (0)131 550 6300
Web: www.sweco.co.uk

Client
EAST DUNBARTONSHIRE COUNCIL

Project Title
A807 - TORRANCE TO MILNGAVIE

Drawing Title
**SECTION 2
GENERAL ARRANGEMENT
SHEET 10 OF 10**

Purpose Of Issue PRELIMINARY					
Status	Status Description				
S0	INITIAL STATUS OR WIP				
Drawn	Designed	Checked	Approved		
CS	CS	MH	AB		
Sheet Size	Scale	Sweco Ref	Revision		
A1	1:250	65211230	P02		
Drawing Number 211230-SWE-ATT-00-D-AT-0060					

